



Prepared by Shannon Gobell
Consultant to Measure Up! 2008

HUGH KILPATRICK MEMORIAL CENTRE
South Western Highway, Boyanup WA 6271
Queries and bookings to Shire of Capel
Ph: 08 9727 0222
Fax: 08 9727 0223
Email: info@capel.wa.gov.au

LOCAL GOVERNMENT
Shire of Capel
Forrest Road, Capel
Capel WA 6271

PO Box 369, Capel WA 6271

Ph: 08 9727 0222
Fax: 08 9727 0223
Email: info@capel.wa.gov.au

CITY/TOWN DESCRIPTION

Boyanup is a small and scenic country town on the banks of the Preston River which lies approximately 21klms south-east of Bunbury and is less than a 3 hour drive from Perth. At last count Boyanup was home to 905 people and whilst small it has a strong feeling of community. Boyanup sits within the Shire of Capel, with a total shire population of just under 12,000 people.

The town of Boyanup situated on the 'Harvest Highway' was gazetted in 1984, and takes its name from the Aboriginal term for the distinguishing feature of this area, 'place of quartz'.

Boyanup is picturesque and has an interesting Transport Museum which includes vintage trains and farm machinery. The Boyanup Farmers Markets provides an opportunity for sampling local fresh produce or purchasing local arts and crafts. Local accommodation in the area includes many B&B's.

It was near historic Boyanup Billabong that the first parcel of land was allocated in Boyanup on May 13, 1845 and the wetlands around the billabong still support numerous varieties of waterfowl.

Boyanup's summer maximum temperature is 40 degrees and summer minimum is 13 degrees, whilst its winter temperatures are considerably less at only 27 degree maximum and a chilly 5 degree minimum. The average yearly rainfall for the area is around 800mm.

EXTERIOR PHOTOS



Front view of Venue



Main Entry door on front of Venue



*Side of Stage doors
(storage/side of stage area)*



*Rear of Stage
(possible load in through side exit doors)*



Parking in front of Venue



Kitchen Loading Dock & Back Door

GENERAL DESCRIPTION

The venue is multipurpose function space that can be used for multiple community purposes including sport, dinners/balls, town functions, exhibitions and live performances. Whilst the venue does have a stage at one end of the hall its focus really is to be able to cater for all community needs and hence feels a little like a school gymnasium and less suited to live performance.

The venue has a commercial kitchen, bar, storage area, very small foyer (or entry vestibule) and male & female toilets. The venue was built in 1983 and then subsequently had evaporative air-conditioning added in 1994. The venue is finished in raw brick on the inside with an acoustic tile ceiling of sorts and has fluoro lighting throughout.

The venue is permitted to 423 people hold under the Heath Act 1911, Health (Public Buildings) Regulations 1992, but I would suggest the space would cater for many more than this, especially in a concert type format.

The venue has approximately 99 black Supafurn plastic chairs with row locking, 275 light brown Sebel plastic chairs, 2 x chair trolleys and 27 x 6' cream coloured laminated trestle tables. Additionally there are 5 grey carpeted pin up boards, 1 x white board, 1 conductor's stand and 1 Behr Bros upright piano.

The venue has a wooden board floor in good condition. The stage too has is a timber board floor, also in good condition. As mentioned above, the venue is air conditioned, with four evaporative air conditioning units (although, as with most large evaporative a/c's, these can be a little noisy when on high). There is no heating in the venue.

The acoustics in the venue are very poor and whilst there appear to be specific acoustic panels in the ceiling these do not fix the terrible acoustic problem that exists within the space.

The venue can achieve a good blackout due to the fact there are no windows in the main hall space. The foyer however does have windows and if performances reliant on a good blackout where to be held during the day then a good system would need to be in place to manage the internal foyer doors to prevent light bleeds.

As mentioned above the venue has both male & female toilets and these on the whole are disability compliant. As the venue is used for sports the toilets do have a locker room style lobby leading in to them and a shower in both the ladies and the men's. It is worth pointing out that these are straight of the side of the space, reasonably close to the stage end and hence noise and light bleeds in the venue are issues to be considered for live performance.

There is no lighting equipment in this venue at all currently, including no patch or even lighting bars. There is a very small and basic audio system in place with a small line mixer/amplifier and 2 small FOH speakers and 2 small foldback speakers. There is a Denon CD/MP3 player. As full access to the "audio lock up box" was not available at the time of this report it is unclear if there are any mics for this system.

Venue load in is straight from the car park through the front glass double doors, through the foyer and onto the auditorium floor at the rear of the venue. Alternatively you could load in from near the rear of the venue's stage and in through the side double doors, but this would be up a set of stairs before reaching the auditorium floor just near the front edge of the stage.

There is limited entertainment power available in the form of 1 x 32amp 5pin 3phase outlet in prompt corner of the stage. There are 4 single phase 10amp double GPO's around the stage area and 5 single phase 10amp double GPO's around the walls of the auditorium/hall.

TOURING TIPS

- Tour all your own technical equipment; there is nothing suitable for professional performance style lighting and audio available in the venue.
- Tour all your own event/show staffing including any crew for load in/out.
- Be mindful of the venues toilet location in relation to any live performance on stage as noise and light bleed could present a problem on occasions.
- There is limited accommodation in the region, so book early or plan to head back to a slightly larger regional town with more touring party accommodation options.
- There are no lighting bars or rigging points so plan to tour all of your own lighting trees.
- There is no way of reaching the ceiling in the venue as there is no lifter and no ladder to reach, hence using girder clamps on the RSJ's in the ceiling would be tricky.
- There are no dressing rooms in the venue, hence artists will need to make do with the storage area side of stage and share the public toilets.
- As the foyer has no air lock, preventing noise and light entering the venue, ensure you put in place your desired patron late entry requirements.
- Check with council re all ticket selling locations or requirements.

INTERIOR PHOTO'S



*Hall - looking towards the stage
(from entry end of hall)*



*Hall - looking towards Bar & Kitchen
(from the stage end of the room)*



Stage in Hugh Kilpatrick Memorial Centre



*Hugh Kilpatrick Memorial Centre Foyer
(taken from main function hall doors)*

DIMENSIONS - All dimensions in mm

STAGE DEPTH (setting line to back wall)	5400
STAGE WIDTH (inc wings)	10845
STAGE HEIGHT	915
PROMPT WING	960
OPPOSITE PROMPT WING	915
STAGE THRUST (setting line to front of thrust stage or apron)	390
STAGE FLOOR TO CEILING Centre	4300
Outside	N/A
STAGE FLOOR TO LX BARS (or available rigging points)	N/A (no LX bars in this venue)
PROSCENIUM WIDTH	6810
PROSCENIUM HEIGHT	3305
STAGE TO BORDER HEIGHT	N/A (no borders in this venue)
AUDITORIUM DEPTH	22390
AUDITORIUM WIDTH	16135
AUD FLOOR TO CEILING Centre	8680
Outsides	6135
(to bottom of A/C vents)	N/A
AUD FLOOR TO FOH LX BARS	N/A (no LX bars in this venue)

Hugh Kilpatrick Memorial Centre

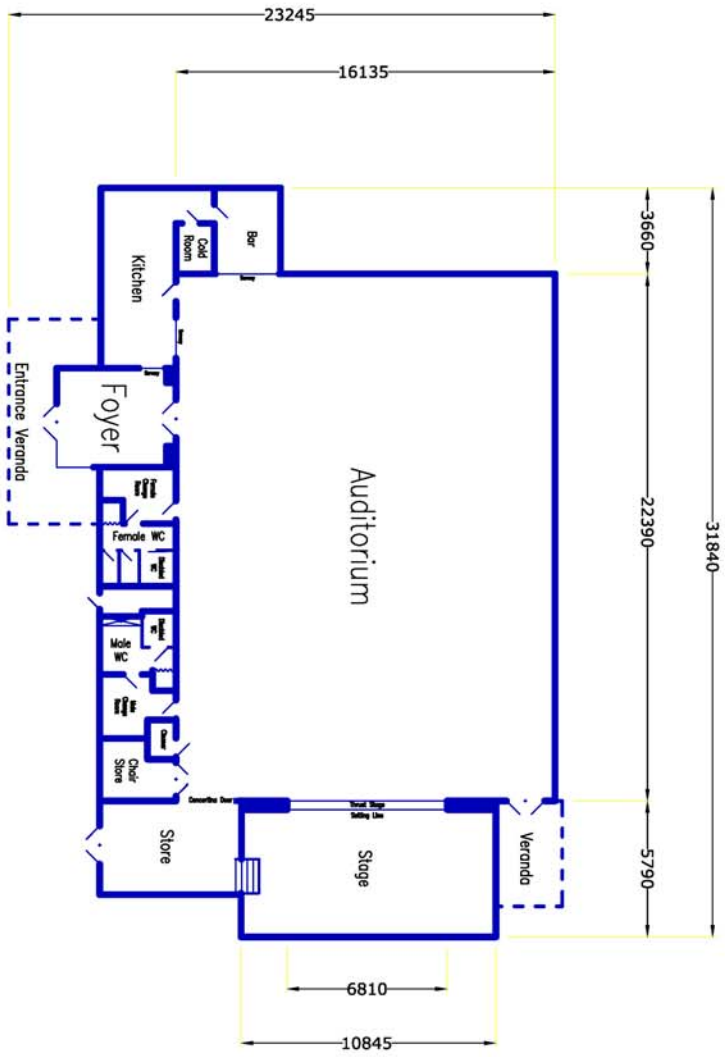

South Western Hwy



Hugh Kilpatrick Memorial Centre	
DRAWN BY: Shannon Gobell	CHECKED BY:
DATE: 18/10/08	CITY/TOWNSHIP: Boyanup
SCALE: 1:200 (on A3)	TITLE: PLAN
DRAWING NO.: 1.0	
Prepared for Country Arts WA	

FLYING FACILITIES & DRAPES

FLYING SYSTEM	N/A
MASKING	None
FOH CURTAIN	Green wool/polyester blend FOH curtain with green cotton backing on a heavy duty domestic track. (3450mm high)
LEGS & BORDERS	2 x masking borders for side of stage drapes (approx 900mm high)
OTHER DRAPES or CURTAINS	2 x black cotton panorama side of stage drapes on domestic tracks (3280mm high x full depth of stage) 1 x black cotton backdrop on domestic track (3500mm high x 8550 wide)
CYCLORAMA	None

LIGHTING FACILITIES

3 PHASE POWER AND LOCATION	One (1) x 32Amp 5pin 3phase outlet is available in the Prompt corner onstage.
OPERATING POSITION (S)	No set position, use location at rear of venue or onstage in wings
LIGHTING DESK	None
DIMMERS AND LOCATION	None
WIRED LIGHTING BARS & NUMBER OF CIRCUITS & LOCATIONS	N/A
PATCHING FACILITIES	None
LAMP STOCK	None
ALTERNATIVE ONSTAGE LIGHTING POSITIONS	None. Rigging would need to be professionally installed into the ceiling to create any sort of usable grid.
ALTERNATIVE FRONT LIGHTING POSITIONS	None. Girder clamps from FOH RSJ steel beams may be possible.
TYPE OF CEILING/ POSSIBLE FIXING POINTS	Suspended acoustic tile ceiling. RSJ beams in ceiling.
BLACKOUT	Good
LADDERS	1 x 8' 'A' Frame aluminium ladder
ONSTAGE 10/15AMP GPO OUTLETS	2 x 10amp double GPO's on Prompt side wall 1 x 10amp double GPO on OP side wall 1 x 10amp double GPO on rear wall
FOH 10/15AMP GPO OUTLETS	1 x 10amp GPO on front of stage 2 x 10amp GPO's on OP auditorium wall 1 x 10amp GPO on auditorium rear wall 1 x 10amp GPO's on Prompt auditorium wall
HOUSELIGHTS	12 dimmable incandescent fixtures in round Perspex dome covers on auditorium walls. Dimmed and switched from left of main entry doors.
WORKING LIGHTS	Fluro's over stage and in auditorium.
HAZER/SMOKE MACHINE	None

SOUND FACILITIES

OPERATING POSITION (S)	The auditorium floor at the back of room or prompt side of stage.
SOUND DESK	None, although, an Australian Monitor AMIS250 self powered line mixer is available.
AMPLIFIERS	None
SPEAKERS	There are 2 speakers permanently mounted, up high, on the pros arch either side of the venue. Four (4) x Australian Monitor XR10 speakers.
FOLDBACK	Two (2) x Australian Monitor XR10 speakers.
FOLDBACK AMPS	No foldback amps.
MICROPHONES	None
MIC STANDS	None
CD OR CASSETTE PLAYERS	Denon single CD/MP3 Player with pitch control (Model: DN C-615)
SENDS	None

COMMUNICATIONS

TALK-BACK	None
TELEPHONES	No phones are available in the venue but there is a public phone at the roadside edge of the car park in front of the venue.
INTERNET	None, but the town has Next G and hence Bigpond wireless modems will work.

ONSTAGE FACILITIES

CROSSOVER	No suitable space for a cross-over is available with only 350mm of space upstage of the rear black backdrop.
WING SPACE	There is very limited amount of wing space available, especially on prompt side (due piano storage and a cut in staircase). The adjacent storage area could be used for additional wing space on Prompt side if required.
TREADS TO FOH	None
LADDER	1 x 8' 'A' Frame aluminium ladder
ROSTRA	None
BLUE WORKLIGHT	None

FRONT OF HOUSE FACILITIES (FOH)

SEATING	There are 99 black Supafurn plastic chairs with row locking and 275 light brown Sebel plastic chairs.
BOX OFFICE	There is a roller shutter from the kitchen to the foyer and hence tickets could be sold through this if required.
BAR	There is a bar located in the rear Prompt corner of the auditorium. The bar shares a cool room with the kitchen.
KITCHEN	Yes, there is a commercial kitchen with a 1 domestic fridge, 1 x commercial oven with a 6 gas burner cook top unit, range hood, Bain Marie/warmer, 1 x Birko 10L urn and plenty of bench space. There is a servery window with roller shutter between the kitchen and the main hall. The kitchen shares a cool room with the bar. There are also 3 first aid kits in the kitchen, 1 industrial and 2 smaller ones.
TOILETS	Male, female toilets are available just off the main hall and both are equipped to handle disabled access.
AIR CONDITIONING	Yes, four (4) evaporative air conditioning units in the auditorium.
HEATING	None

BACKSTAGE FACILITIES

GREEN ROOM	None
DRESSING ROOMS	None
TOILETS	None
SHOWERS	None (however there are showers in the main male and female toilets)
MIRRORS	None
LAUNDRY	No
IRONING	No

BUMP-IN ACCESS

ACCESS DESCRIPTION	Load in from car park side of venue through the foyer and onto the main auditorium floor. Good access is available, with plenty of room for trucks to back up. An alternative load in space can be achieved by loading from the side of the venue (doorway near rear of stage) through a set of double exit doors and onto the auditorium floor, but this is up a set of stairs.
LOADING DOOR SIZE	Main Entry Doors: 1569 wide x 2041 high Rear Exit Doors: 1562 wide x 2026 high
EXTERIOR LIGHTING	Various fluoro's and flood lights are adjacent to all entry/exit doors.
PARKING	Plenty of parking is available in the car park in front of the venue and on street. There is also plenty of space to move trucks and buses around at the rear of the venue if required.
STORAGE	There is very limited storage space for touring parties in lieu of the storage area being required by artists for dressing room space.

EMERGENCY SYSTEMS

SMOKE ALARMS	None
SPRINKLER SYSTEMS	None
FIRE EXTINGUISHERS	There is a small dry chemical fire extinguisher and a fire blanket in the kitchen only.
FIRE HOSES	Fire hoses are fitted.
EMERGENCY EXITS	There are only two emergency exits from the main function space.
EXIT SIGNS	Illuminated exit signs are fitted to the two sets of emergency doors.
MEDICAL CONTACT	There is no nominated medical contact for the venue. Please see medical contacts below.

PRE-SALES

TICKETING SYSTEM	Check with council for ticket selling agencies in town.
ADVERTISING POSITIONS	None at the venue. The bakery across the road from the venue would be one of the best positions to advertise any shows coming to town.
POSTERS/BANNERS	A banner could possibly be set up on the front pine log fence in front of the venue and posters could be placed in the foyer windows or on pin up boards in the foyer of the venue.
LOCAL PUBLICATIONS	The Bunbury Herald and the South Western Times circulate in the Boyanup area.
LOCAL RADIO	There are a number of radio stations covering Bunbury that service the Boyanup area in both AM & FM bands. For further information on radio stations in the area please refer to the following websites: http://www.ausradiostations.com/amwa.html .
WORD OF MOUTH	Word of mouth is a beneficial way to publicise something in Boyanup. Providing media releases to Council and the Tourist Centres within the Shire of Capel offers a quick and cost effective option for spreading the word. The local pub and bakery would also be great word of mouth spreading locations.

OTHER IMPORTANT CONTACTS

HOSPITAL/DOCTOR	Medical services exist with Bunbury. The Bunbury Regional Hospital is located on the Corner of Bussell Highway & Robertson Drive, Bunbury and can be contacted on 08 9722 1000.
PHARMACY	A number of pharmacies exist with the Bunbury area. Two additional pharmacies are located in Donnybrook 15klms south east of Boyanup. Chemmart on 08 9731 1016 and Donnybrook Pharmacy located at 78 South West Highway, Donnybrook on 08 9731 1016.
HARDWARE	A hardware store exists at Donnybrook. Donnybrook Hardware and Rural, located at 47 South Western Hwy, Donnybrook, contact 08 9731 1305. There is also Galvin Hardware 15 klms north east on the way to Bunbury at 12 Sylvan Way, Davenport, contact 08 9725 4812.
COUNCIL	Shire of Capel Office: 08 9727 0222
POLICE, FIRE, AMBULANCE	For all emergency services contact: 000 Police in Donnybrook can be contacted on: 08 9731 1126.
TAXI	There are no taxis in Boyanup. The closest taxi services is Bunbury Taxi Co Op on 08 9721 2300.
NEWSAGENT	For a limited amount of supplies the Boyanup General Store can be contacted on 08 9731 5100.
VISITOR CENTRE	There are a number of Visitor Centres in the Shire of Capel the largest being the Bunbury Visitor Centre on 08 9792 7205 or the Busselton Tourism Centre on 08 9752 1288.
ACCOMODATION	A range of accommodation options exist in Bunbury and Busselton. Limited accommodation exists in Boyanup at the Boyanup Billabong B&B (08 9731 5334) or Meadowbrooke Farm (08 9731 5550). Working with the Shire Visitor Centres is the best way to secure rooms required. Alternatively view the accommodation options at www.capel.wa.gov.au/tourism/accommodation.htm