

## BALINGUP TOWN HALL

Jayes Road, Balingup

Prepared by Alan Surgener  
Consultant to **Measure Up! 2006**  
Country Arts WA

## SHIRE OF DONNYBROOK-BALINGUP

Tel: 08 9780 4200

Email: [shire@donnybrook.wa.gov.au](mailto:shire@donnybrook.wa.gov.au)

Web: [www.donnybrook-balingup.wa.gov.au](http://www.donnybrook-balingup.wa.gov.au)



*Main entrance door on the right*



*Rear view shows Lesser Hall building on right*

## GENERAL DESCRIPTION

Traditional red-brick hall with a 950mm high jarrah floor raked stage, and an estimated concert style capacity of 250 and cabaret style of 120.

At the time of this Measure Up in 2006, the rooms at the front of the building were home to the library and the local physiotherapist. The theatre is rarely used and, although in good structural condition, would be inadequate for most modern day touring productions.

There is no 3-phase power and no lighting bars. The acoustics and sightlines are poor, there is no blackout or backstage facilities and there is a solid wall construction onstage which further reduces an

already small performance area. A suspended ceiling with wired fluorescent lights above the stage makes theatrical onstage lighting almost impossible.

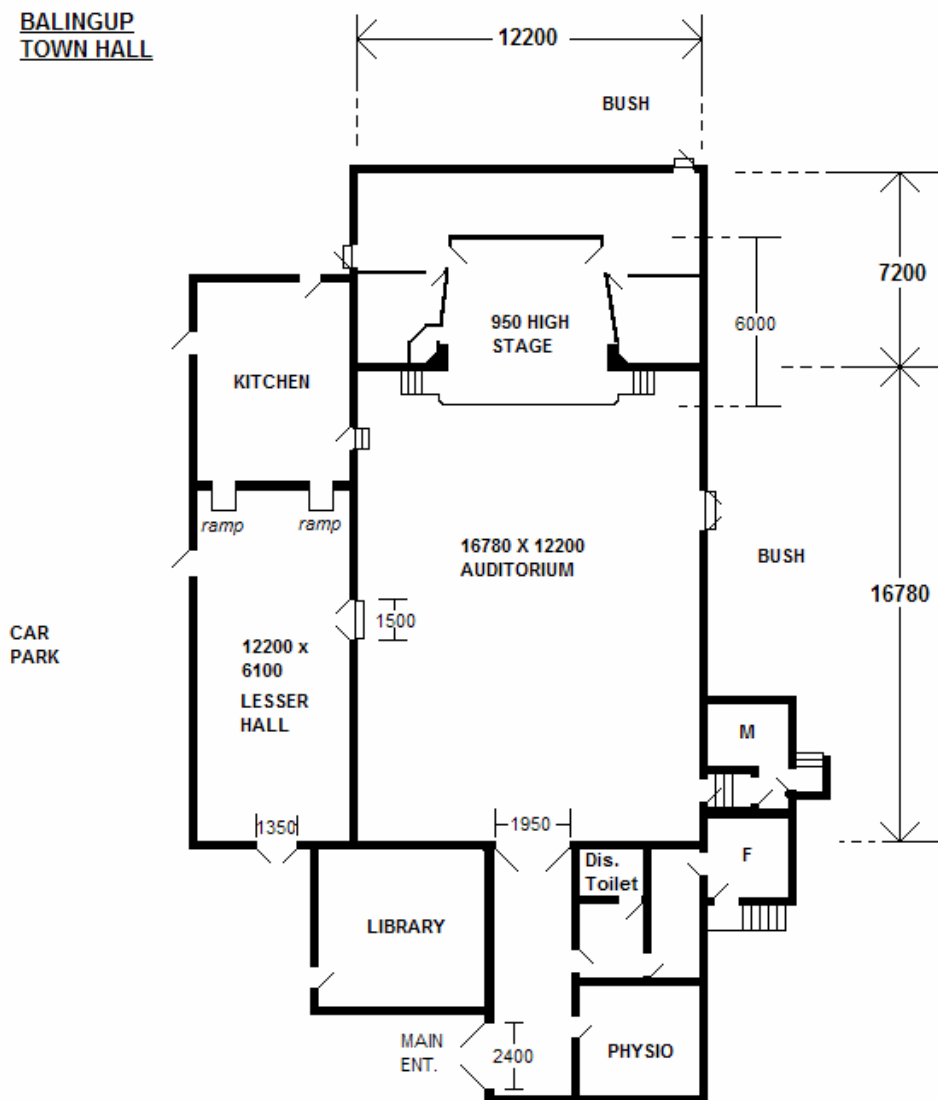

## TOURING TIPS

If you are only expecting an audience of 50 or less, then consider performing in the Lesser Hall. It has a high ceiling and better acoustics. It is easier to heat, and much more intimate.

I am hard pushed to think of anything that could perform on the stage: bring plenty of black wool drapes to create a smaller area and perform on the floor.

Unless further power provision is installed, don't forget to bring a generator.



Proscenium stage



Rear view of auditorium

**Balingup stage floorplan \*hard masking marked in red**

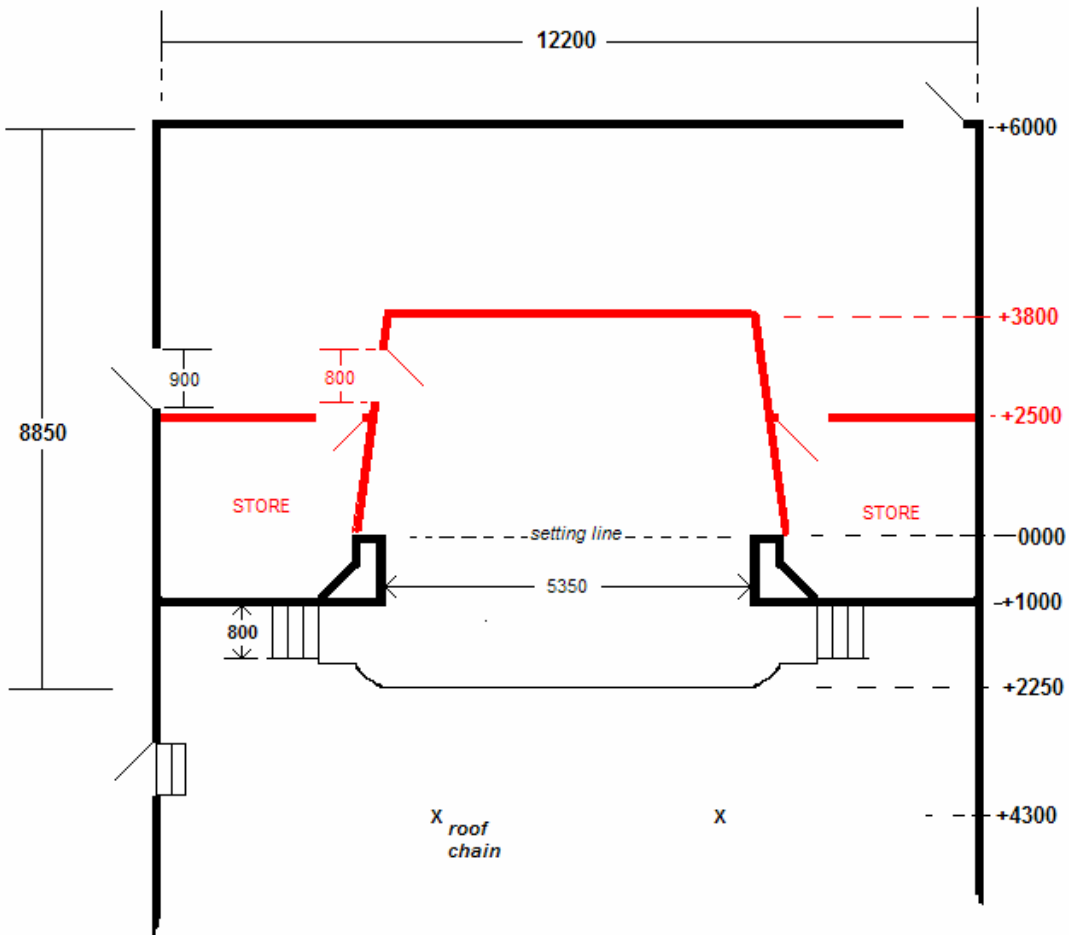

**DIMENSIONS** – All dimensions in mm

|                                  |   |
|----------------------------------|---|
| STAGE DEPTH                      | 6000 to setting line; 8850 to edge of thrust      |
| STAGE WIDTH                      | 12200   |
| STAGE HEIGHT                     | 950   |
| STAGE THRUST                     | 2250  |
| STAGE FLOOR TO TIN ROOF          | 4000 at sides; 6300 to centre apex                |
| STAGE FLOOR TO SUSPENDED CEILING | 3900  |
| STAGE FLOOR TO LX BARS           | N/A   |
| PROSCENIUM WIDTH                 | 5350  |
| PROSCENIUM HEIGHT                | 3660  |
| AUDITORIUM DEPTH                 | 15580 to edge of stage thrust; 16780 wall to wall |
| AUDITORIUM WIDTH                 | 12200   |
| AUD FLOOR TO CEILING             | 4500 at sides; 5500 at flat centre                |
| AUD FLOOR TO LX BARS             | N/A   |

**FLYING FACILITIES**

|               |  |
|---------------|--|
| FLYING SYSTEM | N  |
| MASKING       | Someone has built a solid stud wall (marked in red on stage plan) and then put a suspended ceiling on top of it. |
| CYCLORAMA     | N  |

**LIGHTING FACILITIES**

|   |  |
|---|--|
| 3 PHASE POWER AND LOCATION                              | N  |
| OPERATING LOCATION (S)                                  | None fixed   |
| LIGHTING DESK   | N  |
| DIMMERS AND LOCATION                                    | N  |
| WIRED LIGHTING BARS<br>NUMBER OF CIRCUITS AND LOCATIONS | N  |
| PATCHING FACILITIES                                     | N  |
| LAMP STOCK  | N  |
| ALTERNATIVE ONSTAGE LIGHTING POSITIONS                  | N (There would be if the suspended ceiling was removed).   |
| ALTERNATIVE FRONT LIGHTING POSITIONS                    | There are two chains 5000 apart; sticking out of the plaster ceiling and hopefully attached to a structural roof beam. These are 2100 downstage of the edge of the thrust, and could be used to snap hook a tri-truss or scaffold bar to (just visible on the interior photo). |
| TYPE OF CEILING/<br>POSSIBLE FIXING POINTS              | Solid angle iron roof truss every 3000. But with a flushed plaster ceiling...so anything temporary would be messy. Whip out your pocket scaffolding and rig something off those 2 chains, or use winch up trees.   |
| BLACKOUT  | No. There are five 1400 x 1400 windows, 2500 above the floor which run the full length of the hall and have no curtains. No chance of a daytime focus.   |
| LADDERS   | One 2400 high aluminium A-Frame.   |

|                       |   |
|-----------------------|---|
| ONSTAGE 10AMP OUTLETS | Whoever built the stud wall masking had the foresight to put a double 10 amp socket on each side. Right in the middle 900 high. |
| FOH 10AMP OUTLETS     | Three. One either side of the rear doors, and one beside the double door DSL  |
| HOUSELIGHTS           | Nine flouros operated from 3 switches at rear of auditorium.  |
| WORKING LIGHTS        | On stage flouros.   |

### SOUND FACILITIES

|                        |            |
|------------------------|------------|
| OPERATING POSITION (S) | None fixed |
| SOUND DESK             | N          |
| AMPLIFIERS             | N          |
| SPEAKERS               | N          |
| FOLDBACK               | N          |
| MICROPHONES            | N          |
| MIC STANDS             | N          |
| CD OR CASSETTE PLAYERS | N          |
| SENDS                  | N          |

### COMMUNICATIONS

|            |   |
|------------|---|
| TALK-BACK  | N |
| TELEPHONES | N |
| INTERNET   | N |

### ONSTAGE FACILITIES

|                |   |
|----------------|---|
| CROSSOVER      | N   |
| WING SPACE     | 3 metres each side                                    |
| TREADS TO FOH  | Fixed steep narrow 3-steps at each side of the thrust |
| LADDER         | 2400 high A-frame                                     |
| ROSTRA         | N   |
| BLUE WORKLIGHT | N   |

### FRONT OF HOUSE FACILITIES (FOH) Relates to audience and front staff

|                  |  |
|------------------|--|
| SEATING          | 70 brown plastic stackable; see Shire for more |
| BOX OFFICE       | N  |
| BAR              | N  |
| KITCHEN          | Y  |
| TOILETS          | Y  |
| AIR CONDITIONING | N  |
| HEATING          | N  |

### BACKSTAGE FACILITIES

|                |   |
|----------------|---|
| GREEN ROOM     | N |
| DRESSING ROOMS | N |
| TOILETS        | N |
| SHOWERS        | N |
| MIRRORS        | N |
| LAUNDRY        | N |
| IRONING        | N |

**BUMP-IN ACCESS**

|                    |  |
|--------------------|--|
| ACCESS DESCRIPTION | Nothing useable near the stage.<br>Best parking is at the side of the Lesser Hall but access there is via a standard door...so...use the large double door at the end of the lesser hall and lug through the side door and down the single step. Or come in the front...its so big you could drive a car in...but each trip to the stage is 40 metres there and 40 metres back |
| LOADING DOOR SIZE  | 2400 wide x 2000 high  |
| EXTERIOR LIGHTING  | Yes. At Lesser Hall side and main entrance   |
| PARKING            | Plenty truck size.   |
| STORAGE            | Lesser Hall?   |

**EMERGENCY SYSTEMS**

|                    |   |
|--------------------|---|
| SMOKE ALARMS       | N |
| SPRINKLER SYSTEMS  | N |
| FIRE EXTINGUISHERS | Y |
| FIRE HOSES         | N |
| EMERGENCY EXITS    | Y |
| EXIT SIGNS         | Y |
| MEDICAL CONTACT    |   |

**PRE-SALES**

|                       |  |
|-----------------------|--|
| TICKETING SYSTEM      |  |
| ADVERTISING POSITIONS |  |
| POSTERS/BANNERS       |  |
| LOCAL PUBLICATIONS    |  |
| LOCAL RADIO           |  |
| WORD OF MOUTH         |  |