

**CAMEL LANE THEATRE**  
Camel Lane, Carnarvon  
Tel: 08 9941 4200  
Fax: 08 9941 4199

Prepared by Alan Surgener  
Consultant to **Measure Up! 2006**  
Country Arts WA



### **GENERAL DESCRIPTION**

One of the premier venues on the western seaboard; this proscenium arch, 318 seat tiered theatre has a performance area of 10 metres wide x 8 metres deep.

Full black wool masking with cyclorama; three onstage lx bars on winches and a FOH lx bar accessible by gantry. The auditorium sightlines are perfect.

There is a surround sound speaker system and the acoustics are good to very good.

There are two fully-equipped dressing rooms with laundry facilities backstage, and the direct to stage load-in is excellent.



*Photo taken while cinema screen onstage*

## TOURING TIPS

The sound and lighting equipment available, although adequate, is minimal. If you are intending on doing something flash, then bring your own.

At the time of this report at the end of 2006 there was no sound loom and only 5 sends available through stage floor dips to the FOH control room. There were no facilities to enable sound mixing from the auditorium, a stage monitoring system works, but the control room is soundproofed.

Two-way headset communication from prompt corner to the control room is available, although the sets are old and needing renewed.

## DIMENSIONS – All dimensions in mm

STAGE DEPTH	9100
STAGE WIDTH	18800 (3200 wings space each side)
STAGE HEIGHT	1185
STAGE THRUST	1060
STAGE FLOOR TO GRID	8000
STAGE FLOOR TO LX BARS	7000 maximum out.
PROSCENIUM WIDTH	12400
PROSCENIUM HEIGHT	5000
AUDITORIUM DEPTH	9500
AUDITORIUM WIDTH	18800
AUD FLOOR TO CEILING	8500
AUD FLOOR TO LX BARS	There is a FOH lx gantry 4600 out from edge of stage, the bar is 6000 above stage height

## FLYING FACILITIES

FLYING SYSTEM	No fly tower. Fixed grid with 12 x winch lines.
MASKING	Full black box masking. 4 x wool legs and borders 1 x (wine red) house curtain 1 x black wool French action tab 5300 from edge of stage
CYCLORAMA	Yes

Camel Lane Theatre, Carnarvon - Plan

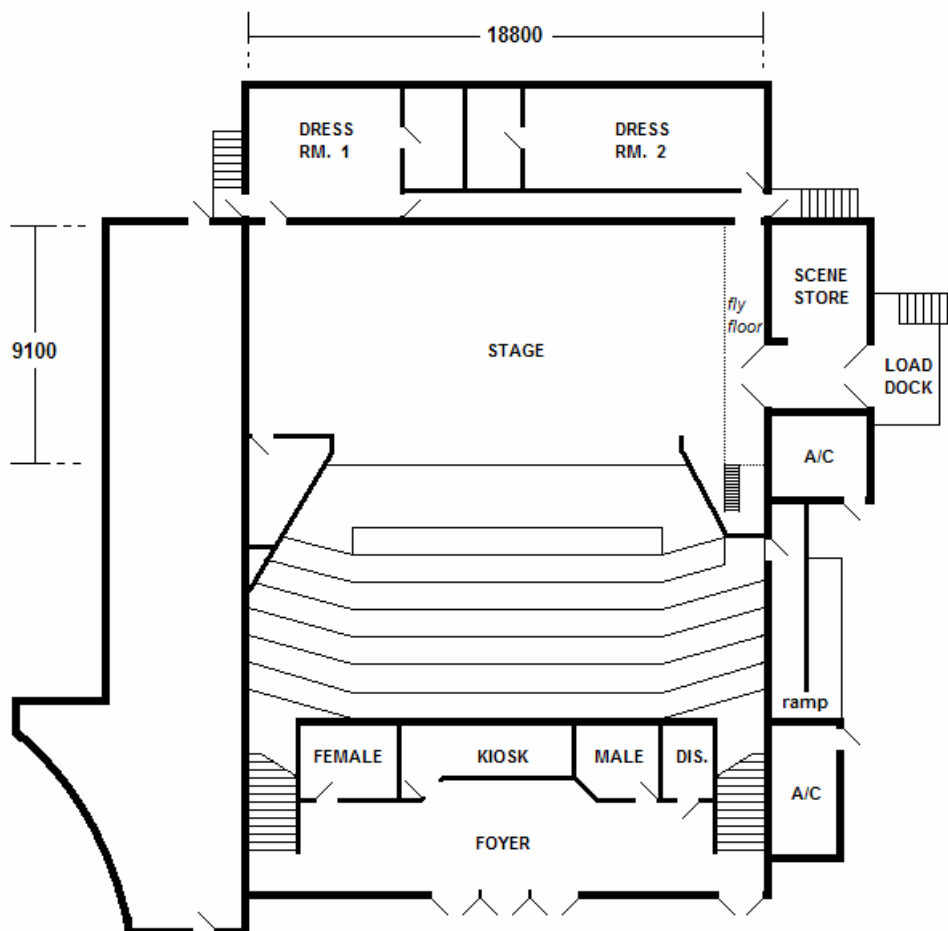

**LIGHTING FACILITIES**

3 PHASE POWER AND LOCATION	One 32-amp three phase supply on each side of the stage. Two in the FOH control room with patching
OPERATING LOCATION (S)	FOH control room
LIGHTING DESK	Jands ESP II
DIMMERS AND LOCATION	48 dimmers in FOH control room
WIRED LIGHTING BARS NUMBER OF CIRCUITS. SEE PLAN FOR LOCATIONS.	FOH Bar 34 circuits Lx 1 10 circuits Lx 2 10 circuits Cyc bar 10 circuits Three stage floor dips on SL 6 circuits Three stage floor dips on SR 6 circuits
PATCHING FACILITIES	In control room
LAMP STOCK	12 x 1kw profile 10 x 1kw fresnels 4 x 650w profiles 12 pairs of par 64's 6 x 500w cyclorama floods 1 x 2kw follow spot with colour changer

ONSTAGE LIGHTING POSITIONS	
FRONT LIGHTING POSITIONS	There is a FOH lx gantry 4600 out from edge of stage, the bar is 6000 above stage height
BLACKOUT	Y
LADDERS	Genie
ONSTAGE 10AMP OUTLETS	4 each side in floor dips
FOH 10AMP OUTLETS	None in auditorium
HOUSELIGHTS	Yes, with 3 settings. * Other side of the control room. Or from prompt corner.
WORKING LIGHTS	Onstage Flouros



*Shows FOH lx gantry and side booms*

### **SOUND FACILITIES**

OPERATING POSITION (S)	Control room
SOUND DESK	Berhinger MX2442
AMPLIFIERS	2 x Mackie power amps FOH/foldback
SPEAKERS	6 x side fill 2 x centre cluster
FOLDBACK	4 x wedges
MICROPHONES	5 x SM 58 4 x SM 57 1 SM 58 wireless handheld
MIC STANDS	4 x uprights
CD OR CASSETTE PLAYERS	2 x basic CD players
SENDS	5

**Camel Lane Theatre - Stage Floorplan - showing flying bars and lx bars**

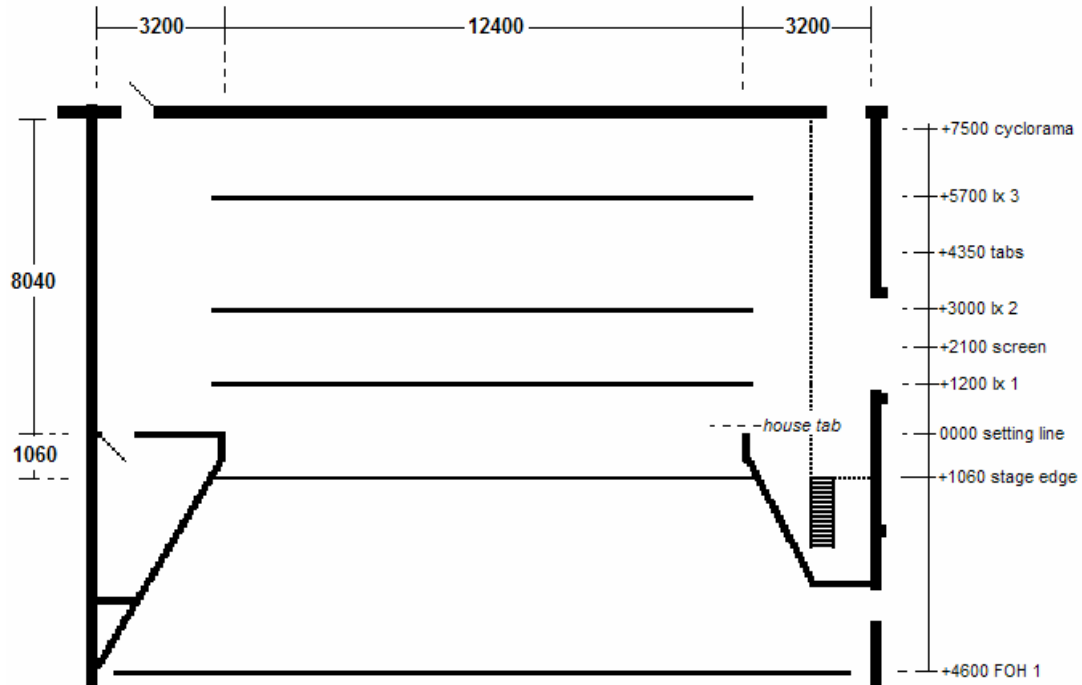

**COMMUNICATIONS**

TALK-BACK	Yes. Headset system available.
TELEPHONES	Yes. Also an internal system.
INTERNET	Yes. Wireless.

**ONSTAGE FACILITIES**

CROSSOVER	Yes. Access to dressing room
WING SPACE	3200 either side
TREADS TO FOH	Fixed side treads 600 wide, 5 steps, each side
LADDER	Genie, 1 X 7ft ladder
ROSTRA	Drum risers.
BLUE WORKLIGHT	Yes

**FRONT OF HOUSE FACILITIES (FOH)** Relates to audience and front staff

SEATING	318 allocated seating. Licensed for 371.
BOX OFFICE	Yes
BAR	Yes
KITCHEN	Yes
TOILETS	Yes
AIR CONDITIONING	Yes
HEATING	! (seldom required in Carnarvon)

**BACKSTAGE FACILITIES**

GREEN ROOM	No
DRESSING ROOMS	2
TOILETS	Yes
SHOWERS	Yes
MIRRORS	Yes
LAUNDRY	Yes
IRONING	Yes

**BUMP-IN ACCESS**

ACCESS DESCRIPTION	Truck height loading bay off DSL
LOADING DOOR SIZE	2320 wide X 2950 high
EXTERIOR LIGHTING	No. Rig a flood
PARKING	Plenty
STORAGE	Yes. SL loading-dock

**EMERGENCY SYSTEMS**

SMOKE ALARMS	Yes
SPRINKLER SYSTEMS	No
FIRE EXTINGUISHERS	Yes
FIRE HOSES	Yes
EMERGENCY EXITS	Yes
EXIT SIGNS	Yes
MEDICAL CONTACT	

**PRE-SALES**

TICKETING SYSTEM	TIKEX, allocated and unallocated seating plans.
ADVERTISING POSITIONS	Front windows, scrolling text screen, local shops.
POSTERS/BANNERS	Front windows, local shops.
LOCAL PUBLICATIONS	The Northern Guardian
LOCAL RADIO	CFM 99.7, 666LN, Carnarvon FM 87.6
WORD OF MOUTH	

**FRIENDLY NEIGHBOURS**

DOCTOR	
HARDWARE	
PUBLICAN	
NEWSAGENT	
PEOPLE TO INFORM	