

**COOROW DISTRICT HALL
MAIN STREET
SHIRE OF COOROW
Tel 08 9952 0100 Fax 08 9952 1173**

Prepared by Alan Surgener
Consultant to **Measure Up! 2005**
Country Arts WA



GENERAL DESCRIPTION

The interior of this building is clean, white and well maintained. This polished jarrah floored venue has an estimated concert style capacity of 250 with an easy side load in access to the auditorium. The acoustics are fair but the venue lacks 3-phase power. There are no lighting positions and no blackout capacity. There is an outdoor toilet block at the rear of the building.

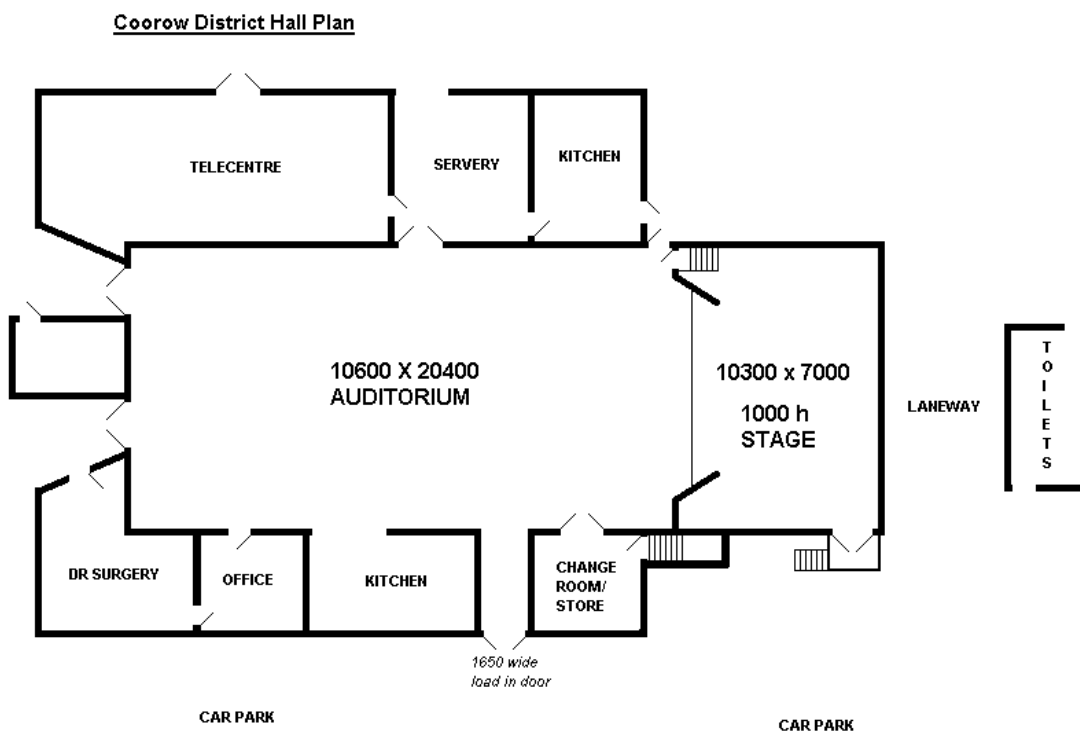

TOURING TIPS

There is no 3-phase in this building.

The auditorium floor creaks noisily throughout.

There is a window on either side of the stage.

There are no lighting bars.

At the time of this measure up plans were being discussed to lease the bottom third of the auditorium to the adjoining telecentre.



DIMENSIONS – All dimensions in mm

STAGE DEPTH	7000
STAGE WIDTH	10300
STAGE HEIGHT	1000
STAGE THRUST	800
STAGE FLOOR TO CEILING	3900
STAGE FLOOR TO LX BARS	No lx bars
PROSCENIUM WIDTH	6700
PROSCENIUM HEIGHT	2700
AUDITORIUM DEPTH	20400
AUDITORIUM WIDTH	10600
AUD FLOOR TO CEILING	4650
AUD FLOOR TO LX BARS	No FOH lx bars

FLYING FACILITIES

FLYING SYSTEM	N
MASKING	N
CYCLORAMA	N

LIGHTING FACILITIES

3 PHASE POWER AND LOCATION	N
OPERATING LOCATION (S)	N
LIGHTING DESK	N
DIMMERS AND LOCATION	N
WIRED LIGHTING BARS NUMBER OF CIRCUITS AND LOCATIONS	N
PATCHING FACILITIES	N
LAMP STOCK	N
ALTERNATIVE ONSTAGE LIGHTING POSITIONS	N
ALTERNATIVE FRONT LIGHTING POSITIONS	N
TYPE OF CEILING/ POSSIBLE FIXING POINTS	Plaster onstage...there are a number of hooks that look like they attach to beams above
BLACKOUT	No. Windows either side of the stage. Windows top of the walls either side of the auditorium.
LADDERS	4000 high A frame for FOH
ONSTAGE 10AMP OUTLETS	TWO UPSTAGE TWO IN FRONT OF THE PROS DSR
FOH 10AMP OUTLETS	No. One in the doctors office and one in the servery near the load in door
HOUSELIGHTS	Fluorescents
WORKING LIGHTS	6 x 100w bulbs above stage

SOUND FACILITIES

OPERATING POSITION (S)	N
SOUND DESK	N
AMPLIFIERS	N
SPEAKERS	N
FOLDBACK	N
MICROPHONES	N
MIC STANDS	N
CD OR CASSETTE PLAYERS	N
SENDS	N

COMMUNICATIONS

TALK-BACK	N
TELEPHONES	N
INTERNET	N

ONSTAGE FACILITIES

CROSSOVER	N
WING SPACE	N
TREADS TO FOH	One set of 1200 wide treads
LADDER	N
ROSTRA	N
BLUE WORKLIGHT	N

FRONT OF HOUSE FACILITIES (FOH) Relates to audience and front staff

SEATING	N
BOX OFFICE	Inaccessible
BAR	N
KITCHEN	Y
TOILETS	N
AIR CONDITIONING	N
HEATING	N

BACKSTAGE FACILITIES

GREEN ROOM	N
DRESSING ROOMS	A store on stage left
TOILETS	N
SHOWERS	N
MIRRORS	N
LAUNDRY	N
IRONING	N

BUMP-IN ACCESS

ACCESS DESCRIPTION	Use side door straight into auditorium. Huge car park area
LOADING DOOR SIZE	2000h x 1650w
EXTERIOR LIGHTING	N
PARKING	Abundant
STORAGE	N

EMERGENCY SYSTEMS

SMOKE ALARMS	N
SPRINKLER SYSTEMS	N
FIRE EXTINGUISHERS	Y
FIRE HOSES	N
EMERGENCY EXITS	Y
EXIT SIGNS	Y
MEDICAL CONTACT	

PRE-SALES

TICKETING SYSTEM	
ADVERTISING POSITIONS	
POSTERS/BANNERS	
LOCAL PUBLICATIONS	
LOCAL RADIO	
WORD OF MOUTH	

FRIENDLY NEIGHBOURS

DOCTOR	
HARDWARE	
PUBLICAN	
NEWSAGENT	
PEOPLE TO INFORM	