

**MALEY PARK COMMUNITY CENTRE**  
**BOTHE STREET**  
**SHIRE OF COOROW**  
 Tel: 08 9952 0100  
 Fax: 08 9952 1173

Prepared by Alan Surgener  
 Consultant to **Measure Up! 2005**  
 Country Arts WA



**GENERAL DESCRIPTION**

Bar, function room and change rooms adjoining a sports oval.  
 Light brown brick, blue carpet and white suspended ceiling with plenty of windows and glass doors.  
 The main function area is L-shaped with the potential to be divided by a concertina door. The largest area has a brick bar in one corner and a potbelly heater on the centre side. Estimated seated audience 50.  
 There is no 3-phase power, and no blackout, but the acoustics are good.

**MALEY PARK COMMUNITY CENTRE - BOTHE STREET, COOROW**

• = 10 amp power point

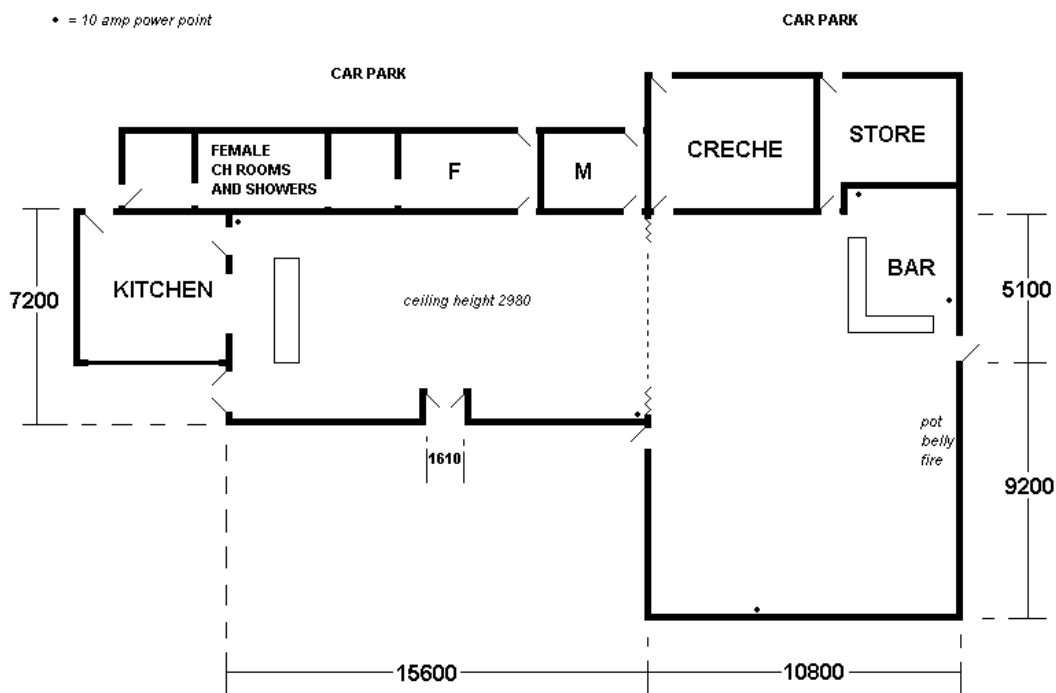

## TOURING TIPS

The double doors are 1610w x 1960h and are on the opposite side of the building to the car park. The ceiling is a low 2980.



Winch up an 8000 tri-truss and create a black backdrop hard against the bar. Or, close the concertina door, pictured above, and perform against it.



The serving bench facing the concertina door, pictured above, can be used as an operating table. Pull power from the kitchen.