



Prepared by Shannon Gobell  
Consultant to Measure Up! 2007

#### **DALWALLINU TOWN HALL**

49-53 Johnston St (Cnr of Myers St) Dalwallinu WA 6609  
Queries and bookings to Michelle Bentlink  
Ph: 08 9661 1001  
Mob: 0428 721 953  
Fax: 08 9661 1097  
Email: [edmo@dalwallinu.wa.gov.au](mailto:edmo@dalwallinu.wa.gov.au)

#### **LOCAL GOVERNMENT**

Shire of Dalwallinu  
58 Johnston St  
Dalwallinu WA 6609

PO Box 141  
Dalwallinu WA 6609

Ph: 08 9661 1001  
Fax: 08 9661 1097  
Email: [shire@dalwallinu.wa.gov.au](mailto:shire@dalwallinu.wa.gov.au)

#### **CITY/TOWN DESCRIPTION**

Dalwallinu is situated in pleasant undulating country in the flourishing northern wheatbelt region. Part of the famous "Wildflower Way", from July to October the area is a mass of colour as flowers carpet the surrounding countryside. Dalwallinu has a population in the shire of approximately 1900 people and the town itself acts as a service hub for this area.

The Shire of Dalwallinu covers an area of 7,187 square kilometres in the Midlands region of Western Australia. It is serviced by a 1,931 kilometre road network, of which 421 kilometres are sealed. The town of Dalwallinu is the administrative centre for the Shire and lies 254 kilometres north-east of Perth on the Great Northern Highway. Other townships in the Shire are Pithara, Kalannie, Buntine and Wubin.

Primary land use is agriculture, which accounts for 575,482 hectares of land or 78 percent of the Shire. The average rural property size is 3,466 hectares.

EXTERIOR PHOTOS



*3D View of front of venue*



*Front of Venue*



*Side of Venue (Myers St)*



*Rear of Venue (& Dressing Room doors)*



*Rear of venue, including space for car parking & bus/truck parking*



*Load in access at Myers St side of venue*



*Alternative load in access straight to stage (at Myers St side of venue)*

## GENERAL DESCRIPTION

The Dalwallinu Town Hall is a pleasant old town hall. The venue appears to have been built around 1929 but there are more recent additions to the rear of the venue with the stage section or everything from the Pros Arch back, including public toilets and dressing rooms, being built well after that.

The venue is reasonably well maintained and whilst some areas are left dusty and unused, like the old projection room and offices at the front of the building, the main areas of use are clean and well looked after. The venue is used fairly often with one of the main users being the local dance classes for the kids, conducted by Perth based dance teachers who travel to Dalwallinu every week.

The venue looks as though it would cater for around 400 to 500 people but there are currently only 140 brown plastic chairs in the venue. I was unable to assess at the time of Measure Up whether the venue had an official capacity under the Health Act of WA 1911, Health (Public Buildings) Regulations 1992, with no official notices posted anywhere within the building. The venue has a reasonable roof height in the main room, and the onstage ceiling height is acceptable too in the confines of a regional town hall. There are no flying facilities at this venue, just 3 fixed lighting bars and a few hung soft furnishings.

The venue has a fairly poor suite of furniture with what is there being in fairly bad shape, beyond the brown plastic chairs mentioned above you will find a very small assortment of other tables. The venue has an upright piano, but again it did not appear to be in great condition. Unlike many town halls, this venue does not actually have any kitchen facilities and hence is limited in terms of flexibility of use.

The venues public toilets are external of the venue as they service both general public services when the building is not operational and then of course toilets for the venue when it is operational. The toilets are not disability compliant, although with some difficulty you a wheelchair may be able to access services in these toilets.

The venue has a reasonable roof height in the main room, but it is worth noting that there are on 50mm bars for hanging or flybars on stage and the onstage roof is quite low anyway.

Acoustically the venue is a not good, with a nasty echo and long reverb time. The venue does not have a blackout and numerous windows around the venue means that whilst one could be achieved it may take some time, a good staple gun and a fair bit of black material.

The venue has very limited and archaic equipment, with only a few pieces of lighting equipment and no audio equipment.

The auditorium floor is of a timber board finish and is in reasonably good condition. The stage also has a timber board floor and it too is in reasonable condition, although would be much more presentable if sanded and resealed.

There are a couple of options to load into the venue, with a set of double doors available in a couple of locations that both lead in to the auditorium floor or you could back the truck straight up to the side of the building and load in through a set of double doors, at truck height, straight onto the stage. There is limited power available in the venue, with only 1 x 30amp 5pin 3phase outlet on stage. There is an assortment of single phase 10A GPO's located on stage and around the venue in general, but not all that many.

## TOURING TIPS

- Tour all your own technical equipment (lighting, audio, etc).
- Tour all your own event/show staffing including any crew for load in/out.
- Ensure the council has relocated any dance classes or other regular local users so as not to have a clash of users in the venue at any one time.
- Bring your own black curtains for blackout purposes, if you require a blackout.
- Book accom well in advance
- Hire a Gen Set if you need more than 30amps a leg of 3phase power.

This is a type of venue where you collect the keys and are left to your own devices. The Economic Development Officer within council would facilitate as much assistance as possible within the council's means though.

## INTERIOR PHOTO'S



*ANZAC Hall - looking towards stage  
(from main entry end of hall)*

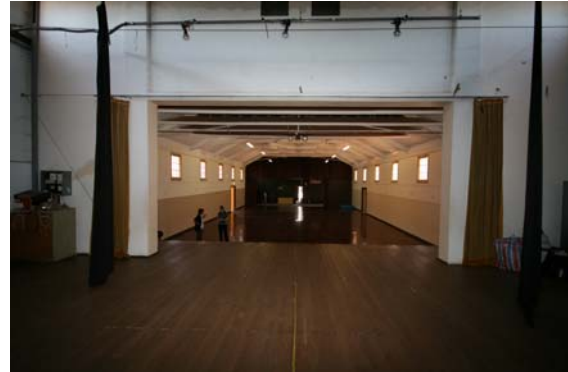

*ANZAC Hall - looking towards stage end  
(from entry)*



*Entry Lobby*

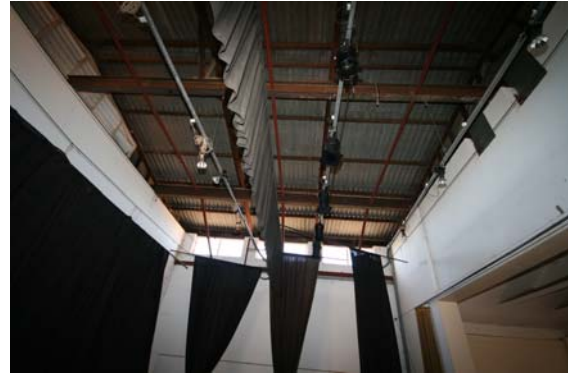

*Stage ceiling and bars*

## DIMENSIONS - All dimensions in mm

STAGE DEPTH (setting line to back wall)	7240
STAGE WIDTH (inc wings)	11615
STAGE HEIGHT	1050
PROMPT WING	2600
OPPOSITE PROMPT WING	2600
STAGE THRUST (setting line to front of thrust stage or apron)	1340
STAGE FLOOR TO CEILING	Centre: 7225 Outsides: 6250
STAGE FLOOR TO LX BARS (or available rigging points)	4445 (to rigging beam: 5800)
PROSCENIUM WIDTH	6415
PROSCENIUM HEIGHT	3400
AUDITORIUM DEPTH	19029
AUDITORIUM WIDTH	11875
AUD FLOOR TO CEILING	
Centre	5635
Outsides	4675
Beams	4385
AUD FLOOR TO LX BARS	N/A

# Dalwallinu Town Hall

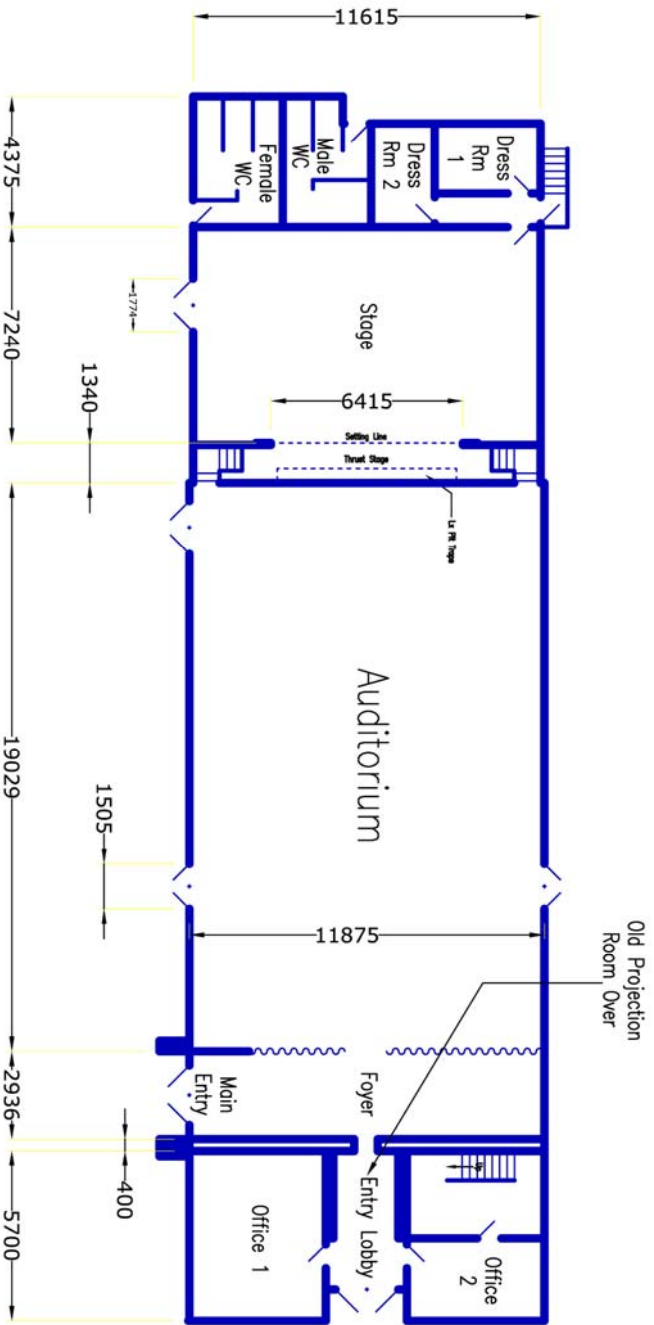

Myers St

Johnston St

Dalwallinu Town Hall	
DRAWN BY: Shannon Gobell	CHECKED BY:
DATE: 21/10/07	CITY/TOWN: Dalwallinu
SCALE: 1:200 (on A3)	TITLE: PLAN
DRAWING NO: 1.0	
Prepared for Country Arts WA	

# Dalwallinu Town Hall

## Stage Plan & LX Bars

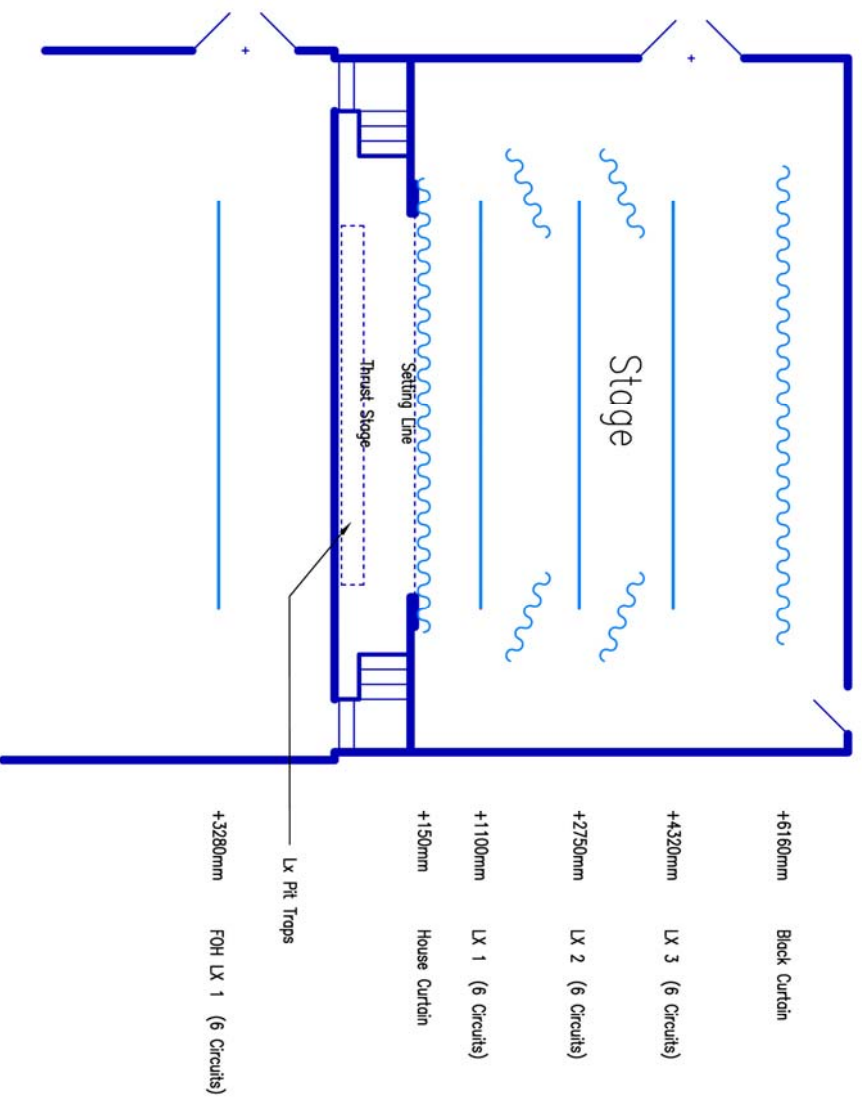

\*Please Note: All Lx bars are at fixed heights and all curtains are at fixed heights. No bars fly.

\*Please Note: All measurements are in millimetres and are taken from the setting line.



Dalwallinu Town Hall – Stage Plan	
DRAWN BY: Shannon Gobell	CHECKED BY:
DATE: 21/10/07	CITY/TOWN: Dalwallinu
SCALE: 1:100 (on A3)	TITLE: STAGE PLAN VIEW
DRAWING NO: 1.1	
Prepared for Country Arts WA	

## FLYING FACILITIES & DRAPES

FLYING SYSTEM	No flying system installed
MASKING	No masking, No blackout available
FOH CURTAIN	Yes, but not great. Mustard yellow in colour and tab track is not very heavy duty hence tracking is not great.
LEGS & BORDERS	1 Border (mid stage) & 3 legs per side
OTHER DRAPES or CURTAINS	1 x Black curtain at back of stage
CYCLORAMA	1 x white curtain

## LIGHTING FACILITIES

3 PHASE POWER AND LOCATION	One(1) x 30Amp 5pin 3phase outlet on stage in prompt corner
OPERATING POSITION (S)	The auditorium floor at the back of the room or from side of stage would be the two best positions to operate from
LIGHTING DESK	1 x very old Jands 2 preset 12ch Lighting Desk
DIMMERS AND LOCATION	1 x very old Strand 4ch Minipak
WIRED LIGHTING BARS NUMBER OF CIRCUITS AND LOCATIONS	Four circuit tube lighting bars are fitted in this venue, with 6 circuits on each.
PATCHING FACILITIES	Patching facilities are available in Prompt corner of the stage. There are 4 looms of 6 circuits coming in from the 1 x FOH Lx Bar and 3 on-stage Lx Bars. Totalling 24 patch outlets throughout the venue.
LAMP STOCK	7 x Par 38 (rigged at on stage) 6 x Par 56 (300w) 3 x 500w Floods (rigged at FOH)
ALTERNATIVE ONSTAGE LIGHTING POSITIONS	There are plenty of beams that you could rig trussing from for the purposes of hanging lighting in the ceiling above the stage. <i>**Please note this is not terribly high though.</i>
ALTERNATIVE FRONT LIGHTING POSITIONS	N/A
TYPE OF CEILING/ POSSIBLE FIXING POINTS	Fibro board ceiling. No real opportunity for fixing points in the auditorium.
BLACKOUT	No, but could be achieved with a ladder and lots of black curtains.
LADDERS	Yes, 5m 'A' frame ladder is available.
ONSTAGE 10AMP OUTLETS	There are limited 10amp GPO's onstage and around the venue.
FOH 10AMP OUTLETS	As above.
HOUSELIGHTS	Fluros, with standard light switches.
WORKING LIGHTS	Fluros

## SOUND FACILITIES

OPERATING POSITION (S)	No specific position, but I would recommend the auditorium floor at the back of room.
SOUND DESK	None
AMPLIFIERS	None
SPEAKERS	None
FOLDBACK	None
AMPS	None
MICROPHONES	None
MIC STANDS	None
CD OR CASSETTE PLAYERS	None in venue, but there are a few 'ghetto blasters' that the local dance school use.
SENDS	N/A

## COMMUNICATIONS

TALK-BACK	None
TELEPHONES	None in venue, but there are public phones near by. There is a quirky old Airphone system in the venue to communicate from FOH to Stage, but I would rely on this. The venue has been wired for Telstra phone lines but none are currently connected. These could be reconnected if required.
INTERNET	None, but the town has Next G and hence Bigpond wireless modems will work.

## ONSTAGE FACILITIES

CROSSOVER	There is a crossover behind the white curtain at the rear of the stage.
WING SPACE	Minimal wing space of around 2600mm per side is available.
TREADS TO FOH	There are staircases, one each side of stage, leading from the thrust stage down to the auditorium floor. These are inset into the thrust stage.
LADDER	Yes, 5m 'A' frame ladder is available.
ROSTRA	None
BLUE WORKLIGHT	No working blue Lx system

## FRONT OF HOUSE FACILITIES (FOH)

SEATING	There are 140 brown plastic chairs available for audience seating in the venue. Please speak further with the Council if more chairs are required, as there may be other community resources.
BOX OFFICE	There is no box office space in this venue and any tickets sold on the night of performance would have to be sold from a table near the entrance doors.
BAR	No
KITCHEN	There is no kitchen in the venue.
TOILETS	Male and female toilets are available, but they are located externally to the venue.
AIR CONDITIONING	No
HEATING	No

## BACKSTAGE FACILITIES

GREEN ROOM	No
DRESSING ROOMS	There are two (2) 4/5 person dressing rooms, fitted with lights, benches and mirrors. These are in very bad condition though.
TOILETS	No
SHOWERS	No
MIRRORS	Yes
LAUNDRY	No
IRONING	No

## BUMP-IN ACCESS

ACCESS DESCRIPTION	A suitable load in can be achieved through the set of double doors on Myers St side of the venue, as shown in the picture above. The load in is a flat load in from street level straight in to venue's auditorium floor level. There is an alternative load in door at stage height (possibly close to truck height too), this access is straight in onto stage.
LOADING DOOR SIZE	Double Doors at side of venue leading to stage are 1704mm wide. Double Doors at side of venue leading to the auditorium are 1505mm wide.
EXTERIOR LIGHTING	Various fluros and floods are located on the exterior of the venue.
PARKING	Plenty of parking is available around the venue site, including plenty of space to move trucks and buses around.
STORAGE	A small internal storage space is available, in the office spaces at the front of the building or the old supper room adjacent to the venue.

## EMERGENCY SYSTEMS

SMOKE ALARMS	No smoke alarms or fire alarm systems are fitted.
SPRINKLER SYSTEMS	None
FIRE EXTINGUISHERS	Yes, various extinguishers as per modern BCA requirements are fitted.
FIRE HOSES	Yes, 1 is fitted on the outside of the building (Myers St side)
EMERGENCY EXITS	There are three main emergency exits for the venue and also the main entrance can be used as an emergency exit too, totalling four.
EXIT SIGNS	Exit signs are fitted to all emergency doors.
MEDICAL CONTACT	There is no nominated medical contact for the venue. Please see medical contacts below.

## PRE-SALES

TICKETING SYSTEM	Tickets sold through local shop outlets, the Council's Economic Development Officer will assist in identifying ticket sales outlets.
ADVERTISING POSITIONS	None at venue.
POSTERS/BANNERS	Posters could be placed in the venues glass entry doors
LOCAL PUBLICATIONS	The Central Midlands & Costal Advocate covers the Dalwallinu township and surrounding areas.
LOCAL RADIO	There are few radio stations covering Dalwallinu in both AM & FM bands, but they include; Spirit Radio Network 6SAT (104.5fm), WAFM 6FMS (106.1fm), Radio National 6ABCRN (107.5fm) and various am stations. For further information on radio stations in the area please refer to the following websites: <a href="http://www.ausradiostations.com/fmwa.html">http://www.ausradiostations.com/fmwa.html</a> <a href="http://www.ausradiostations.com/amwa.html">http://www.ausradiostations.com/amwa.html</a>
WORD OF MOUTH	Word of mouth is a positive way to publicise something in Dalwalinu and providing media releases of detailed info to a number of key businesses (i.e. the pub, council, Telecentre) would certainly spread the word.

## OTHER IMPORTANT CONTACTS

HOSPITAL/DOCTOR	Dalwallinu District Hospital can be contacted on: 08 9661 0200. Dalwallinu Medical Centre can be contacted on: 08 9661 1203.
PHARMACY	Dalwallinu Pharmacy can be contacted on: 08 9661 1041
HARDWARE	Dalwallinu Hardware can be found on Johnston St and contacted on: 08 9661 1080
COUNCIL	Local Shire Office: 08 9661 1001
POLICE, FIRE, AMBULANCE	For all emergency services contact: 000 Dalwallinu Police Station can also be contacted on: 08 9661 1202
TAXI	No taxi service available
NEWSAGENT	Pia's Newsagency can be contacted on: 08 9661 1110
VISITOR CENTRE	Visitor Centre can be found on Park Dr and contacted on: 08 9661 1001
ACCOMODATION	There are only a few accommodation options in Dalwallinu. I would recommend the Dalwallinu Wheatland Motel as this is the largest and most modern, with a restaurant Dalwallinu Wheatland Motel: 08 9661 1600