

## KALBARRI SPORT & RECREATION CENTRE

Porter St, Kalbarri WA 6536

Queries and bookings to Malcolm Scott, Kalbarri Sport & Rec Club

Ph: 08 9937 1800

Fax: 089937 1822

Email: m&fscott@bigpond.com

## LOCAL GOVERNMENT

Shire of Northampton

## CITY/TOWN DESCRIPTION

Kalbarri is approximately a 6 & ½ hour drive from Perth and a quite pleasant 45 minute ride off the North West Coast Highway. The way in from the north or south is on a sealed surface and is very scenic. Seasonal rains or the flooding of the Murchinson River does not affect the access to the town. Kalbarri itself is a beautiful seaside town, very popular in school holiday periods. There is much accommodation available in town but it may need to be booked well in advance if planning to be in Kalbarri in peak seasons. The town has a population of approximately 1400.

## EXTERIOR PHOTOS



*View of front of venue (from Oval)*



*3D view of venue (showing ramp)*



*Load in Access from car park*



*Load in Access double doors*

## **GENERAL DESCRIPTION**

This venue is recently refurbished or has been extended to now include a function space that accommodates approx 200 people. Essentially the venue is a Footy club room style venue with a relatively low ceiling. The function room section is in very good condition having only just recently been built. Further to the main function room space is a large veranda which flows on from the main room through a large set of sliding doors. The venue could be used in a couple of different ways with a small performance inside or a 'band' style performance could be held on the veranda facing out onto the oval which obviously has no patron limit. The space inside is acoustically quite good with a perforated acoustic baffle style ceiling, however there is a small echo/reverb effect under the veranda.

The venue has both male and female toilets suitable in size to match the venue size and also has a disabled toilet at the rear of the venue. The venue is disability compliant with good access through all doors and a disability ramp accessing down to the adjacent oval.

The venue also has a reasonable suite of furniture and equipment suited to the style of venue it is including; various tables, white bistro chairs, casual cane wicker chairs, padded function chairs, TV, Plasma screen, Bain Marie and stereo.

The venue also has a kitchen space with various fridges and facilities within. A servery window through to the main function space is fitted.

The main function space has a lino floor in excellent condition with a carpeted section at one end of the room. If a performance were to be held at this venue I would suspect the carpeted section makes the best sense in terms of where any stage or performance space should be set up. The room does not have a blackout, in fact there are a lot of windows and glass doors in the room, making it very difficult to try and apply any blackout treatments. The veranda has a concrete finish on the floor and also has a set or tiled stairs in the centre leading down to the oval below. Its worth noting that the venue, both the main function room inside and the veranda outside, is approx 2m above the level of the oval. The veranda has a sloped away grass section falling from the veranda down to the oval level. The venue has only an 80amp mains switchboard, with only one (1) 20Amp 5 pin 3phase outlet available on the outside of the venue, on the veranda under a bench. The location of the 3phase power outlet is close to the carpeted section of the venue which would seem to be the natural performance end and hence a feed could be tucked through a window very easily with a small extension lead.

## **TOURING TIPS**

This is the type of venue where you will need to tour all your own technical equipment, and staging. The venue is a blank canvass and you would need to tour everything with you, including all of the staffing you may require to load in/out and run the show.

This is a type of venue where you collect the keys and are basically left to your own devices. However the Kalbarri Sport & Rec Club are very keen to have touring events stop in Kalbarri and hence would offer as much support as is physically possible within their means.

## INTERIOR PHOTOS



*Main side function space*



*Function space, facing towards sliding doors to oval*



*Function space, facing towards Kitchen & Toilets*



*Function space facing Kitchen and Toilets*

## DIMENSIONS - All dimensions in mm

STAGE DEPTH	N/A
STAGE WIDTH	N/A
STAGE HEIGHT	N/A
STAGE THRUST	N/A
STAGE FLOOR TO CEILING	N/A
STAGE FLOOR TO LX BARS	N/A
PROSCENIUM WIDTH	N/A
PROSCENIUM HEIGHT	N/A
AUDITORIUM DEPTH	N/A
AUDITORIUM WIDTH	N/A
AUD FLOOR TO CEILING	N/A
AUD FLOOR TO LX BARS	N/A

# Kalbarri Sport & Rec Centre

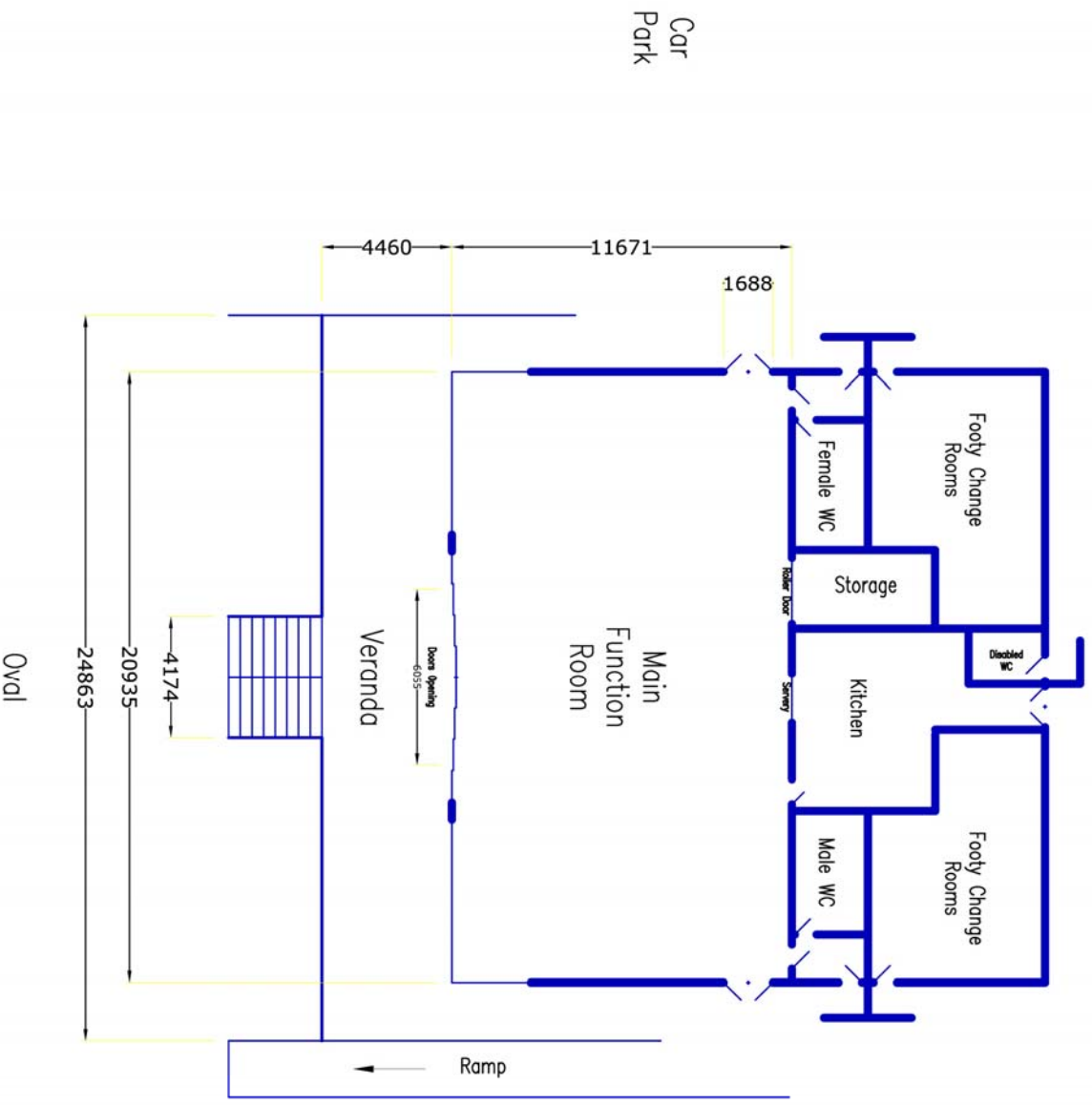

Kalbarri Sport & Rec Centre		CHECKED BY:
DRAWN BY:	Shannon Gobell	
DATE:	10/10/07	CITY/TOWN:
		Kalbarri
SCALE:	1:200 (on A3)	TITLE:
		PLAN
		DRAWING NO:
		1.0
Prepared for Country Arts WA		

# Kalbarri Sport & Rec Centre



Front Elevation

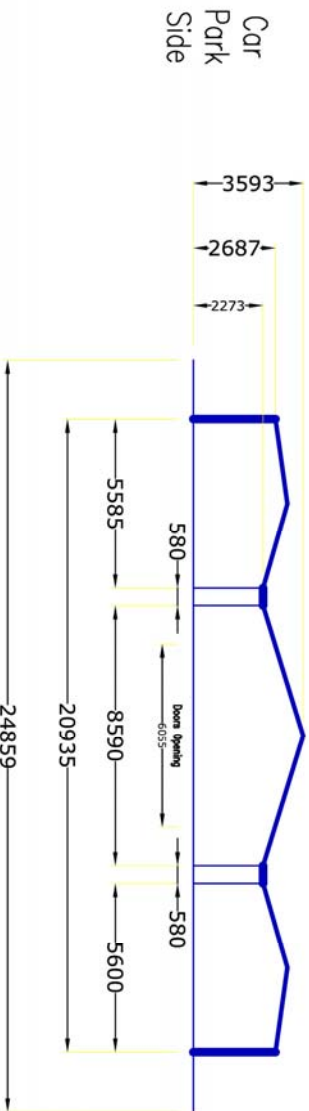

Kalbarri Sport & Rec Centre		CHECKED BY:
DRAWN BY:	Shannon Gobell	
DATE:	10/10/07	CITY/TOWN:
SCALE:	1:200 (on A3)	TITLE:
		ELEVATION
		DRAWING NO: 1.0
Prepared for Country Arts WA		

## FLYING FACILITIES

FLYING SYSTEM	N/A
MASKING	No masking, No Blackout available
CYCLORAMA	N/A

## LIGHTING FACILITIES

3 PHASE POWER AND LOCATION	One (1) 20Amp 5pin 3phase outlet is available on the veranda outside (under the seating bench)
OPERATING LOCATION (S)	N/A
LIGHTING DESK	None
DIMMERS AND LOCATION	None
WIRED LIGHTING BARS NUMBER OF CIRCUITS AND LOCATIONS	N/A
PATCHING FACILITIES	N/A
LAMP STOCK	None
ALTERNATIVE ONSTAGE LIGHTING POSITIONS	N/A
ALTERNATIVE FRONT LIGHTING POSITIONS	N/A
TYPE OF CEILING/ POSSIBLE FIXING POINTS	Gyprock ceiling in some sections and perforated steel corrugated sheets in other sections. No temp fixing points available.
BLACKOUT	No
LADDERS	None in venue, but KS&RC would find one if needed.
ONSTAGE 10AMP OUTLETS	There is an assortment of 10amp & 15amp GPO's around the venue.
FOH 10AMP OUTLETS	As above.
HOUSELIGHTS	Fluros, with standard light switches
WORKING LIGHTS	Fluros, as above.

## SOUND FACILITIES

OPERATING POSITION (S)	N/A
SOUND DESK	None
AMPLIFIERS	None
SPEAKERS	None
FOLDBACK	None
MICROPHONES	None
MIC STANDS	None
CD OR CASSETTE PLAYERS	There is a stereo within the function room
SENDS	N/A

## COMMUNICATIONS

TALK-BACK	None
TELEPHONES	Yes, 1 standard phone
INTERNET	None, but the town has Next G and hence Bigpond wireless modems will work.

## ONSTAGE FACILITIES

CROSSOVER	N/A
WING SPACE	N/A
TREADS TO FOH	N/A
LADDER	None in venue, but KS&RC would find one if needed.
ROSTRA	None
BLUE WORKLIGHT	N/A

## FRONT OF HOUSE FACILITIES (FOH) Relates to audience and front staff

SEATING	There are approx 200 white plastic bistro chairs available for audience seating at events.
BOX OFFICE	None at venue
BAR	To be built soon.
KITCHEN	Yes, (still being fitted out at the time of the report).
TOILETS	Male, Female and Disabled Toilets all available
AIR CONDITIONING	No, but the venue has lots of overhead fans.
HEATING	No.

## BACKSTAGE FACILITIES

GREEN ROOM	N/A
DRESSING ROOMS	There are two (2) 'Footy' style change rooms which could be utilised as dressing room spaces.
TOILETS	Above change rooms have toilets
SHOWERS	Above change rooms have showers
MIRRORS	Above change rooms have mirrors
LAUNDRY	None
IRONING	No facilities, but available at most accommodation facilities in town.

## BUMP-IN ACCESS

ACCESS DESCRIPTION	A suitable load in can be achieved through the set of double doors on the car park side of the venue, as shown in the picture above. The load in is a flat load in from car park level straight in to venue floor level.
LOADING DOOR SIZE	1688mm
EXTERIOR LIGHTING	Various fluros and floods are located on the exterior of the venue.
PARKING	Plenty of parking is available around the venue site, including plenty of space to move trucks and buses around. The parking is in an unformatted fashion though.
STORAGE	A small internal storage space is available.

## EMERGENCY SYSTEMS

SMOKE ALARMS	At the time of Measure Up no smoke alarms appeared to be fitted.
SPRINKLER SYSTEMS	N/A
FIRE EXTINGUISHERS	Yes, various extinguishers as per BCA requirements are fitted.
FIRE HOSES	Yes, hose reels as per BCA requirements are fitted.
EMERGENCY EXITS	The two main emergency exits for the venue are the same two main entrance doorways on either side of the venue.
EXIT SIGNS	Exit signs are fitted to all emergency doors as per the BCA requirements
MEDICAL CONTACT	There is no nominated medical contact for the venue. Please see medical contacts below.

## PRE-SALES

TICKETING SYSTEM	Tickets sold through local shop outlets, KS&RS will assist with this process.
ADVERTISING POSITIONS	None at venue, but a banner could be hung.
POSTERS/BANNERS	As above.
LOCAL PUBLICATIONS	The Geraldton Guardian newspaper covers the Kalbarri township and surrounding areas.
LOCAL RADIO	There are numerous radio stations covering Kalbarri in both AM & FM bands, most based from or fed from Geraldton. For further information on radio stations in the area please refer to the following websites: <a href="http://www.ausradiostations.com/fmwa.html">http://www.ausradiostations.com/fmwa.html</a> <a href="http://www.ausradiostations.com/amwa.html">http://www.ausradiostations.com/amwa.html</a>
WORD OF MOUTH	Word of mouth is a positive way to publicise something in Kalbarri and providing media releases of detailed info to a number of key agencies would certainly spread the word.

## OTHER IMPORTANT CONTACTS

DOCTOR	Doctor can be contacted at: 08 9937 1159 Medical Ctr can be contacted at: 08 9937 0100 Chemist can be contacted at: 08 9937 1026
HARDWARE	BP Kalbarri & Makit Hardware are located on the same property in town and can be contacted on: 08 9937 1800 (open 7 days 6.30am to 6pm)
COUNCIL	Local Shire Office: 08 9937 1409
POLICE, FIRE, AMBULANCE	For all emergency services contact: 000
TAXI	Taxi's can be contacted at: 08 9937 1888
NEWSAGENT	Kalbarri Newsagency contact: 08 9937 1102
VISITOR CENTRE	Visitor Centre contact number is: 08 9937 1104
ACCOMODATION	There are several accommodation options in town with Kalbarri being a very popular seaside holiday area, especially in peak seasons. I would recommend two accommodation options in particular given their size to facilitate a tour party, facilities and location; Kalbarri Palm Resort Best Western: 08 9937 2333 Kalbarri Beach Resort: 08 9937 1061