



Prepared by Shannon Gobell
Consultant to Measure Up! 2007

LAKE KING SPORTS PAVILION

Lake King-Newdegate Road
LAKE KING WA 6356
Queries and bookings to Erika Meijbaum
c/- Post Office, Lake King
Ph: 08 9874 4004
Fax: 08 9874 4005
Email: erika.meijbaum@landmark.com.au

LOCAL GOVERNMENT

Shire of Lake Grace
1 Bishop Street
LAKE GRACE WA 6353

PO Box 50
LAKE GRACE WA 6353

Ph: 08 9890 2500
Fax: 08 9890 2599
Email: shire@lakegrace.wa.gov.au

CITY/TOWN DESCRIPTION

Lake King is named for the major feature of the area, Lake King, and is located five and a half hours' drive east of Perth and 67 kms north-west of Ravensthorpe. Lake King is ideally situated as a stopover for travellers crossing arid country between Perth, Esperance and the Nullarbor Plain. Lake King is home to only a very small community, with a population of 219 people within Lake King and the surrounding area. The nearest towns are Lake Grace - 113kms west or Ravensthorpe - 73kms south/south east.

Lake King is a major grain growing region, the main crops being wheat, canola, barley and lupins. Cattle and sheep are also raised, the cattle for meat and the sheep for both meat and wool. The town marks the point where a formed gravel road takes a shortcut across immense inland sand flats to Norseman, and although there are no services for over 300 kilometres, it does pass through the interesting arid wilderness contained by Frank Hahn National Park. Lake King is in the middle of salt lake country and is noted for its amazing and spectacular wildflower display each spring, as well as access to the Rabbit Proof Fence and the rock climber's favourite, Peak Charles.

The area's salt lakes form a chain, believed to be the remnants of an ancient river system, formed during the early tertiary period (some 60 million years ago), when the climate was supposedly wetter than it is at present. The area has a temperate climate, with cool evenings and an average annual rainfall of 340 mm.

EXTERIOR PHOTOS



3D View of front of venue



Sports field outside front doors



Main Entry Doors (Load in Access)



Rear of Venue



Sports courts at rear of venue



Public Toilets at rear of venue

GENERAL DESCRIPTION

The Lake King Sports Pavilion as the name suggests is a sporting club adjacent to the grassed sports playing field, netball/basketball courts and tennis courts in Lake King. The sports pavilion, built in 1971, is a very small but well looked after. The venue has a main sports club room, female dressing room facilities and 2 male change room facilities (footy club change room style). The venue has a large BBQ function area at the rear of the venue. This venue is right next door to the Lake King Pioneer Memorial Hall and hence I can not see it being of great use for any sort of performing arts or touring shows.

The venue is licensed to hold 93 people in the function space and has a kitchen for catering or running "canteen" type activities. The venue has approximately 70 chairs, 10 square function tables, 2 trestle tables, a Mipro "spruikers" PA system with mic, 2 x white boards and a TV.

The floor is tiled throughout, fluros in the ceiling and a bar has been built into the centre of the room. The acoustics in the venue are quite acceptable. As this is a sports club, as you would expect, there are windows right across the front of the building facing out to the sports playing field and hence no blackout is possible for performances.

The venue has both male and female toilets suitable in size to match the venue's capacity and a disability toilet is also available.

There is no entertainment technical equipment in this venue at all.

Venue load in is via the car park, along the front veranda and through a set of double doors into the venue. It's a flat load in with no stairs. There is no entertainment power (3phase) available. There are very few single phase GPO's around the stage area or venue.

TOURING TIPS

- This venue is really designed solely for sports use and clubhouse type use and hence does not suit touring shows or performances. I would recommend using the Lake King Pioneer Memorial Hall just next door to this venue instead.

As with many regional venues this is the type of venue where you collect the keys (from the local school next door) and are left to your own devices.

INTERIOR PHOTO'S



*Lake King Sports Pavilion
entry end of venue (view from main doors)*



*Lake King Sports Pavilion
(from female change room end)*



Canteen style kitchen in Sports Pavilion



View of Sports Pavilion from kitchen

DIMENSIONS - All dimensions in mm

STAGE DEPTH (setting line to back wall)	N/A
STAGE WIDTH (inc wings)	N/A
STAGE HEIGHT	N/A
PROMPT WING	N/A
OPPOSITE PROMPT WING	N/A
STAGE THRUST (setting line to front of thrust stage or apron)	N/A
STAGE FLOOR TO CEILING Centre	N/A
Outsides	N/A
STAGE FLOOR TO LX BARS (or available rigging points)	N/A
PROSCENIUM WIDTH	N/A
PROSCENIUM HEIGHT	N/A
STAGE TO BORDER HEIGHT	N/A
AUDITORIUM DEPTH	8630
AUDITORIUM WIDTH	12850
AUD FLOOR TO CEILING Centre	N/A
Outsides	N/A
AUD FLOOR TO LX BARS	N/A

Lake King Sports Pavillion

Sports
Oval

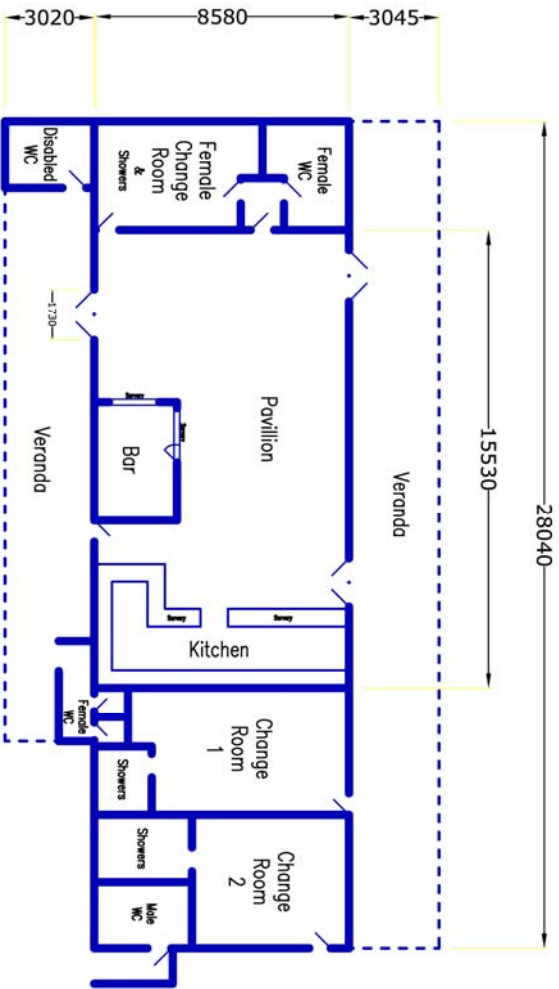

Car Park

Courts

Road



Lake King Sports Pavillion	
DRAWN BY: Shannon Gobell	CHECKED BY:
DATE: 26/10/07	CITY/TOWN: Lake King
SCALE: 1:200 (on A3)	TITLE: PLAN
DRAWING NO.: 1.0	
Prepared for Country Arts WA	

FLYING FACILITIES & DRAPES

FLYING SYSTEM	N/A
MASKING	No blackout available.
FOH CURTAIN	N/A
LEGS & BORDERS	N/A
OTHER DRAPES or CURTAINS	N/A
CYCLORAMA	None

LIGHTING FACILITIES

3 PHASE POWER AND LOCATION	None
OPERATING POSITION (S)	Anywhere on the floor
LIGHTING DESK	None
DIMMERS AND LOCATION	None
WIRED LIGHTING BARS NUMBER OF CIRCUITS AND LOCATIONS	None
PATCHING FACILITIES	N/A
LAMP STOCK	None
ALTERNATIVE ONSTAGE LIGHTING POSITIONS	N/A
ALTERNATIVE FRONT LIGHTING POSITIONS	N/A
TYPE OF CEILING/ POSSIBLE FIXING POINTS	Gyprock ceiling. No fixing points available.
BLACKOUT	No, but could be achieved with some black material.
LADDERS	None
ONSTAGE 10AMP OUTLETS	N/A
FOH 10AMP OUTLETS	There are a few 10Amp outlets around the venue
HOUSELIGHTS	Fluros, with standard light switches.
WORKING LIGHTS	Fluros.

SOUND FACILITIES

OPERATING POSITION (S)	Anywhere on the floor
SOUND DESK	None
AMPLIFIERS	None
SPEAKERS	Small Mipro self powered "spruikers" PA system
FOLDBACK	None
FOLDBACK AMPS	None
MICROPHONES	None
MIC STANDS	None
CD OR CASSETTE PLAYERS	None
SENDS	N/A

COMMUNICATIONS

TALK-BACK	None
TELEPHONES	None
INTERNET	None, but the town has Next G and hence Bigpond wireless modems will work.

ONSTAGE FACILITIES

CROSSOVER	N/A
WING SPACE	N/A
TREADS TO FOH	N/A
LADDER	None
ROSTRA	None
BLUE WORKLIGHT	N/A

FRONT OF HOUSE FACILITIES (FOH)

SEATING	There is a licensed capacity of 93 people. There are 70 plastic chairs of assorted colour in the venue.
BOX OFFICE	N/A
BAR	Yes, a bar is available in this venue.
KITCHEN	Yes, there is a good size kitchen with a fridge, oven/cook top, pie warmer, Bain Marie, 2 x microwaves and bench space. The Kitchen is not soundproofed from the venue, in fact it serves straight into the venue "canteen" style.
TOILETS	Male, female and disability toilets are available
AIR CONDITIONING	No, There is no air-conditioning fitted into the venue.
HEATING	Yes, there is some heating in the venue.

BACKSTAGE FACILITIES

GREEN ROOM	N/A
DRESSING ROOMS	There are sports change room facilities available.
TOILETS	Yes
SHOWERS	Yes
MIRRORS	Yes
LAUNDRY	No
IRONING	No

BUMP-IN ACCESS

ACCESS DESCRIPTION	The best load in for this venue is through the front double doors, off the veranda, and into the venue. The load in is a flat load in from street level straight in to venue's floor level.
LOADING DOOR SIZE	Double doors at side of venue are 1640mm wide.
EXTERIOR LIGHTING	Various fluros and floods are located on the exterior of the venue.
PARKING	Plenty of parking is available at the rear and side of the building, including plenty of space to move trucks and buses around.
STORAGE	There is no storage space for touring parties to utilise.

EMERGENCY SYSTEMS

SMOKE ALARMS	No smoke alarms or fire alarm systems are fitted.
SPRINKLER SYSTEMS	None
FIRE EXTINGUISHERS	Yes, various extinguishers as per modern BCA requirements are fitted.
FIRE HOSES	None
EMERGENCY EXITS	There are three emergency exits for the venue, including the main entrance.
EXIT SIGNS	Exit signs are fitted to all emergency doors.
MEDICAL CONTACT	There is no nominated medical contact for the venue. Please see medical contacts below.

PRE-SALES

TICKETING SYSTEM	Tickets sold through local shop outlets, Council will assist in identifying ticket sales outlets.
ADVERTISING POSITIONS	None at venue, but a banner could be hung on an adjacent fence line.
POSTERS/BANNERS	As above. Posters could be placed into the venue windows.
LOCAL PUBLICATIONS	The Lakes Links news covers Lake King and surrounding areas.
LOCAL RADIO	Radio WAFM 6FMS (92.5fm) transmits in the Lake King area. For further information on radio stations in the area please refer to the following websites: http://www.ausradiostations.com/fmwa.html http://www.ausradiostations.com/amwa.html
WORD OF MOUTH	Word of mouth is a positive way to publicise something in Lake King and providing media releases to council and a number of key businesses (i.e. the pub) would certainly spread the word.

OTHER IMPORTANT CONTACTS

HOSPITAL/DOCTOR	There did not appear to be any medical facilities in Lake King. Lake Grace provides the closest facilities.
PHARMACY	There is no chemist available in Lake King.
HARDWARE	There is no hardware store in Lake King.
COUNCIL	Shire of Lake Grace - Shire Office: 08 9890 2500
POLICE, FIRE, AMBULANCE	For all emergency services contact: 000 Local police can also be contacted at Lake Grace on 08 9865 1007 or Ravensthorpe on 08 9838 1004
TAXI	No taxi service available
NEWSAGENT	Newspapers and basic stationary are available at the corner store; other newsagency supplies are limited but could be sourced from nearby Lake Grace or Ravensthorpe.
VISITOR CENTRE	The Visitor Centre is located within the Shire Council offices of Lake Grace, the contact number is: 08 9890 2500
ACCOMODATION	There is a limited amount of accommodation in Lake King and as such only a small amount of persons could be accommodated. There are a number of accommodation options in nearby Lake Grace or Ravensthorpe. I would suggest either; Lake King Tavern: 08 9874 4048 Lakes Break Bed & Breakfast: 08 9874 4007