

NANNUP TOWN HALL
Warren Road, Nannup

Prepared by Alan Surgener
Consultant to **Measure Up! 2006**
Country Arts WA

SHIRE OF NANNUP

Tel: 08 9756 1018

Email: Nannup@nannup.wa.gov.au

Web: www.nannup.wa.gov.au



Main front entrance



Rear view from village green

GENERAL DESCRIPTION

Originally built in 1903 this beautifully maintained hall is, in my opinion, the best example of its period in WA. A unique tin fascia proscenium arch, polished jarrah floor and auditorium walls set it above the rest, providing an honest charm and a good reason for preservation.

A tightly packed 200 concert style seating capacity, or an estimated 80 cabaret style, make this an ideal venue for smaller acts or bands.

The stage is small, and the proscenium low, but the acoustics are surprisingly good. Easy load in and centrally located.

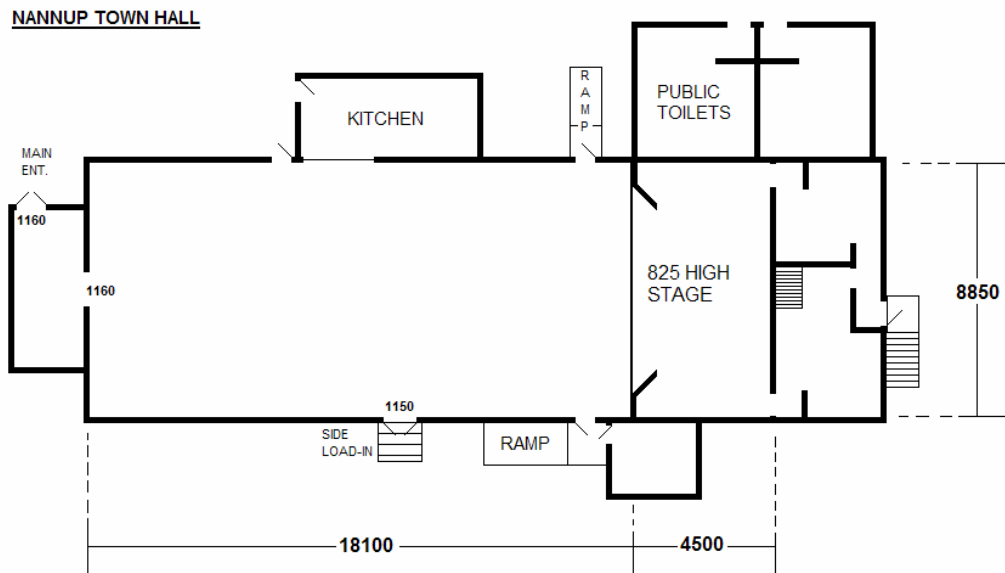

TOURING TIPS

There is a 2700 high jarrah walkway on the back wall. This is accessed via steep stairs from the dressing room, and I have absolutely no idea why it is there, and the masking is more of an obstruction than a help.

The only 10amp power points in the auditorium are located high up on the side walls and are normally used to start the gas heaters so pull power from the kitchen.

There are no toilets backstage.



DIMENSIONS – All dimensions in mm

STAGE DEPTH	4500
STAGE WIDTH	8850
STAGE HEIGHT	825
STAGE THRUST	750
STAGE FLOOR TO CEILING	3200 at sides; 5850 at peaked centre
STAGE FLOOR TO LX BARS	*4200 to exposed 4"x 2" wooden joists
PROSCENIUM WIDTH	6150
PROSCENIUM HEIGHT	2880
AUDITORIUM DEPTH	18100
AUDITORIUM WIDTH	8850
AUD FLOOR TO CEILING	4030 at sides; 4960 at flattened centre
AUD FLOOR TO LX BARS	3900

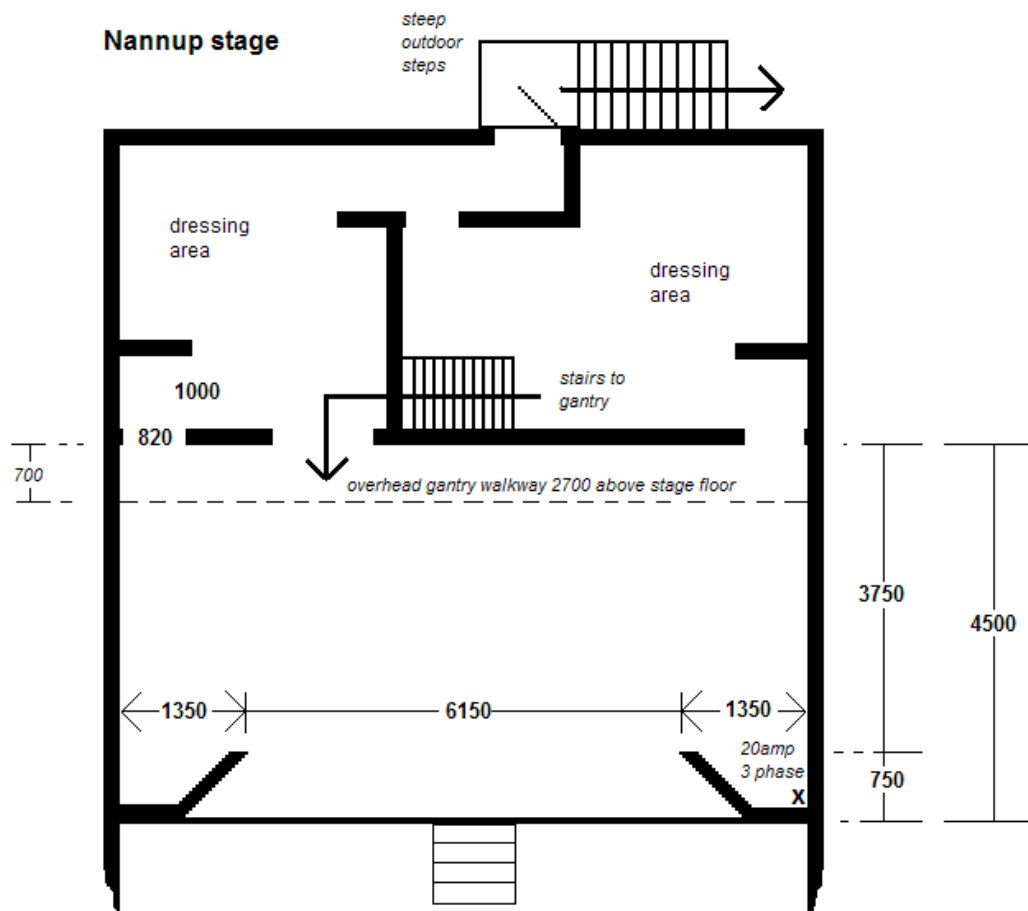

FLYING FACILITIES

FLYING SYSTEM	N
MASKING	2 sets cotton black legs and very low borders
CYCLORAMA	N

LIGHTING FACILITIES

3 PHASE POWER AND LOCATION	20 amp LOCATED DSL
OPERATING LOCATION (S)	N
LIGHTING DESK	5 CHANNEL 10 AMP QUINTET
DIMMERS AND LOCATION	N
WIRED LIGHTING BARS NUMBER OF CIRCUITS AND LOCATIONS	N
PATCHING FACILITIES	N
LAMP STOCK	3 X 500W MINUM 23
ALTERNATIVE ONSTAGE LIGHTING POSITIONS	There are 4 wooden joists 5000 long that are 4200 above the stage floor. With further investigation, these joists may be suitable as lighting points. You would have to suspend a scaffold bar by chain first.
ALTERNATIVE FRONT LIGHTING POSITIONS	There are exposed iron rod roof supports every 3 metres that could take an underslung scaffold bar or truss.
TYPE OF CEILING/ POSSIBLE FIXING POINTS	Fibro material – check with the Shire
BLACKOUT	5 windows in the hall but all with good, solid black curtains. 60% blackout during the day, just enough for a daytime focus.
LADDERS	N
ONSTAGE 10AMP OUTLETS	Only two double sockets. One in each DS corner.
FOH 10AMP OUTLETS	Six. But they are used for starting the gas heaters. Pull power from the kitchen hatch.
HOUSELIGHTS	Six overhead on/off operated from power box at the end of the hall.
WORKING LIGHTS	Four x 60w globes over stage, operated from DSR.

SOUND FACILITIES

OPERATING POSITION (S)	None fixed. Use a trestle table
SOUND DESK	N
AMPLIFIERS	N
SPEAKERS	N
FOLDBACK	N
MICROPHONES	N
MIC STANDS	N
CD OR CASSETTE PLAYERS	N
SENDS	N

COMMUNICATIONS

TALK-BACK	N
TELEPHONES	N
INTERNET	N

ONSTAGE FACILITIES

CROSSOVER	Yes. There is a door USL and USR leading from the upstage dressing area
WING SPACE	N
TREADS TO FOH	Yes. A heavy jarrah 4-stepper that can be moved
LADDER	N
ROSTRA	N
BLUE WORKLIGHT	N

FRONT OF HOUSE FACILITIES (FOH) Relates to audience and front staff

SEATING	Yes. Original jarrah rows.
BOX OFFICE	N
BAR	Kitchen hatch. Licence available on request
KITCHEN	Y
TOILETS	Outside public toilets
AIR CONDITIONING	
HEATING	Gas heaters in auditorium

BACKSTAGE FACILITIES

GREEN ROOM	N
DRESSING ROOMS	Y
TOILETS	Outside public toilets
SHOWERS	N
MIRRORS	One on the wall of the smaller change area
LAUNDRY	N
IRONING	N

BUMP-IN ACCESS

ACCESS DESCRIPTION	Park out the front on the street and load in from the front door, or side load up the four steps.
LOADING DOOR SIZE	The side double door is the largest 1160 wide x 2200 high
EXTERIOR LIGHTING	Y
PARKING	Street parking only. Truck or small van could be parked beside the side load-in door.
STORAGE	N

EMERGENCY SYSTEMS

SMOKE ALARMS	N
SPRINKLER SYSTEMS	N
FIRE EXTINGUISHERS	Y
FIRE HOSES	N
EMERGENCY EXITS	Y
EXIT SIGNS	Y Two in the auditorium
MEDICAL CONTACT	Nearest hospital 800 metres away

PRE-SALES

TICKETING SYSTEM	N
ADVERTISING POSITIONS	4 Square, Ampol and post office, bottle shop etc
POSTERS/BANNERS	
LOCAL PUBLICATIONS	
LOCAL RADIO	
WORD OF MOUTH	