

## SHARK BAY TOWN HALL

Hughes Street, Denham

Prepared by Alan Surgener  
Consultant to **Measure Up!** 2006  
Country Arts WA

### Shire of Shark Bay

Tel: 08 9948 1218

Email: [admin@sharkbay.wa.gov.au](mailto:admin@sharkbay.wa.gov.au)

Web: [www.sharkbay.wa.gov.au](http://www.sharkbay.wa.gov.au)



### GENERAL DESCRIPTION

This charming hall was built in 1977. The prime users, the Shark Bay Film Club and the Shark Bay Arts Council, ensure that the building is well maintained. The Film Club leaves their excellent speaker system permanently installed, although admit to an uphill battle with the auditorium's acoustic problems.

A 600mm high x 7200mm wide x 3600mm deep rostra stage has been placed at one end, leaving seating room for about 150 people.

There is a beautiful new wood floor and black roller-blinds on the side windows.

### TOURING TIPS

At the time of writing this report, the 15 amp three-phase supply does not work.

There are no lighting bars or backstage dressing room facilities.

The community of Denham is commonly referred to as Shark Bay, a popular tourist destination.



**DIMENSIONS** – All dimensions in mm

STAGE DEPTH	4800 collapsible rostra
STAGE WIDTH	7200 collapsible rostra
STAGE HEIGHT	600 collapsible rostra
STAGE THRUST	n/a
STAGE FLOOR TO CEILING	n/a
STAGE FLOOR TO LX BARS	n/a – no lighting bars
PROSCENIUM WIDTH	n/a
PROSCENIUM HEIGHT	n/a
HALL DEPTH	17800
HALL WIDTH	11780
HALL FLOOR TO CEILING	3300 at sides/4500 at centre peak
AUD FLOOR TO LX BARS	n/a – no lighting bars

**FLYING FACILITIES**

FLYING SYSTEM	n/a
MASKING	Around cinema screen only
CYCLORAMA	N



*Projection room*



*Side windows with black roller-blinds*

**Denham Shark Bay Town Hall (floorplan and end elevation)**

■ = EXPOSED RSJ

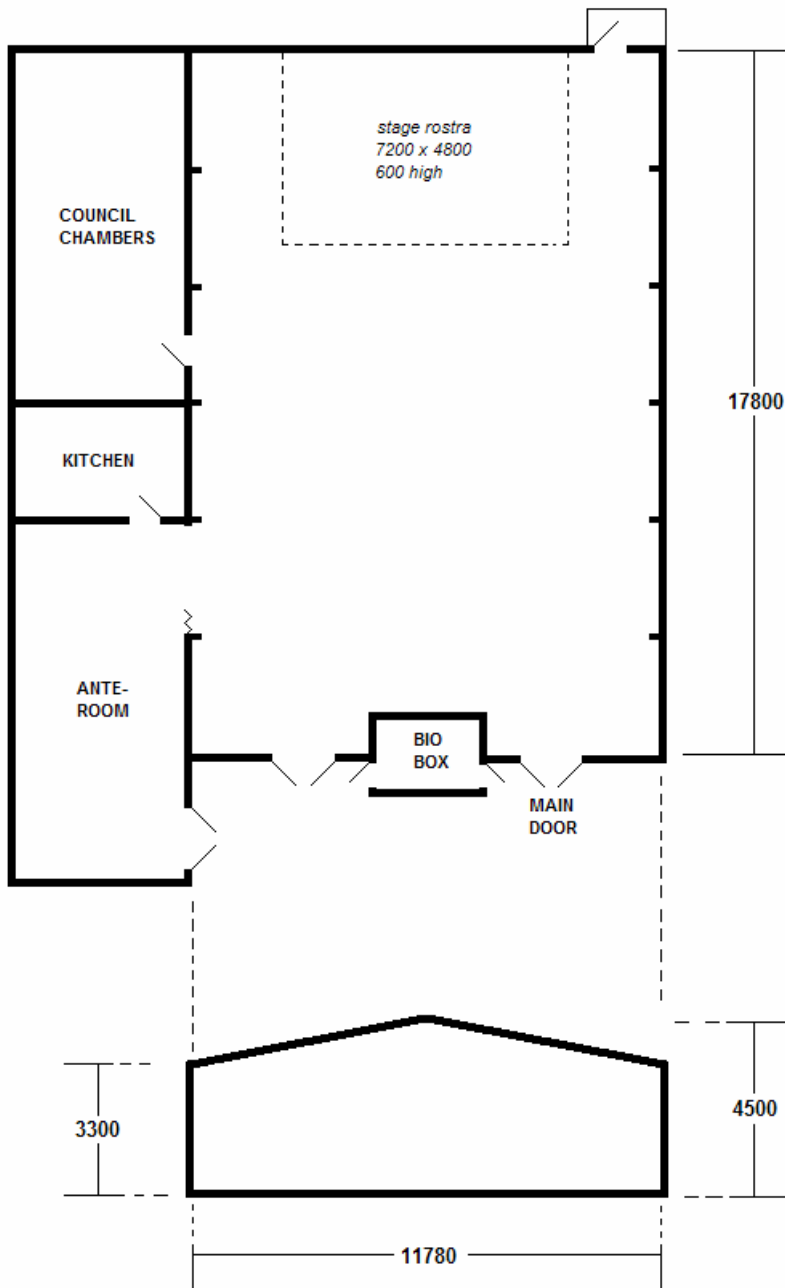

### LIGHTING FACILITIES

3 PHASE POWER AND LOCATION	One 15amp supply on the bottom of the wall USC. (Not working at time of writing this report)
OPERATING LOCATION (S)	N
LIGHTING DESK	N
DIMMERS AND LOCATION	N
WIRED LIGHTING BARS NUMBER OF CIRCUITS AND LOCATIONS	N
PATCHING FACILITIES	N
LAMP STOCK	N
ALTERNATIVE ONSTAGE LIGHTING POSITIONS	Exposed reinforced steel joists every 3 metres. See photo and plan.
ALTERNATIVE FRONT LIGHTING POSITIONS	
TYPE OF CEILING/ POSSIBLE FIXING POINTS	
BLACKOUT	Y
LADDERS	N
ONSTAGE 10AMP OUTLETS	Y
FOH 10AMP OUTLETS	Y
HOUSELIGHTS	N
WORKING LIGHTS	Flouros

### SOUND FACILITIES

OPERATING POSITION (S)	N
SOUND DESK	*For sound equipment use please contact the Shark Bay Film Club (via Shire Office). The speaker set-up is configured 5.1 surround style. There are a few boom stands, a few microphones, and a small mixer.
AMPLIFIERS	
SPEAKERS	
FOLDBACK	
MICROPHONES	
MIC STANDS	
CD OR CASSETTE PLAYERS	
SENDS	

### COMMUNICATIONS

TALK-BACK	N
TELEPHONES	
INTERNET	

### ONSTAGE FACILITIES

CROSSOVER	N
WING SPACE	2300mm either side
TREADS TO FOH	2 x moveable treads
LADDER	N
ROSTRA	16 rostra sections 1800mm x 1200mm x 600mm Grey tops + black skirt
BLUE WORKLIGHT	

**FRONT OF HOUSE FACILITIES (FOH)** Relates to audience and front staff

SEATING	Loose plastic chairs
BOX OFFICE	N
BAR	N
KITCHEN	Y
TOILETS	Public toilets outside the Hall.
AIR CONDITIONING	N
HEATING	N

**BACKSTAGE FACILITIES**

GREEN ROOM	N
DRESSING ROOMS	N
TOILETS	N
SHOWERS	N
MIRRORS	N
LAUNDRY	N
IRONING	N

**BUMP-IN ACCESS**

ACCESS DESCRIPTION	Main front door
LOADING DOOR SIZE	1600mm wide x 2000mm high
EXTERIOR LIGHTING	N
PARKING	Limited
STORAGE	N

**EMERGENCY SYSTEMS**

SMOKE ALARMS	N
SPRINKLER SYSTEMS	N
FIRE EXTINGUISHERS	
FIRE HOSES	
EMERGENCY EXITS	Y
EXIT SIGNS	Y
MEDICAL CONTACT	

**PRE-SALES**

TICKETING SYSTEM	
ADVERTISING POSITIONS	
POSTERS/BANNERS	
LOCAL PUBLICATIONS	
LOCAL RADIO	
WORD OF MOUTH	

**FRIENDLY NEIGHBOURS**

DOCTOR	
HARDWARE	
PUBLICAN	
NEWSAGENT	
PEOPLE TO INFORM	Shark Bay Arts Council and the Shark Bay Film Club – get latest contact details for both volunteer groups from the Shire of Shark Bay